



COMMONWEALTH OF PENNSYLVANIA  
DEPARTMENT OF ENVIRONMENTAL PROTECTION  
OIL & GAS MANAGEMENT PROGRAM

DEP USE ONLY	
Auth # 1559736	APS # 1156803
Site # 886345	Facility # 890261
FIX Client #	Sub-fac # 1469931

## Request for Approval of Alternative Waste Management Practices

*Please read instructions on back before completing this form.*

Well Operator Scorpio Energy, Inc.		DEP ID 300597	Well Permit or Registration Number <b>053-31203</b>	
Address 203 Center Street			Well Farm Name Hastings	
City Sheffield	State PA	Zip Code 16347	Well # SDT-67	Serial #
Phone 814-727-7717	Fax 814-727-7718	County Forest County	Municipality Howe Township	

**INTENDED ALTERNATIVE PRACTICE** *Check the appropriate box and complete the applicable section of the form.*

- For temporary containment of fluids and wastes generated during drilling, altering, or completing a well, complete Section A. PITS AND TANKS FOR TEMPORARY CONTAINMENT. See 25 Pa. Code § 78.56 for regulations.
- For disposal of drill cuttings from above the surface casing seat, complete Section B. ALTERNATE WASTE DISPOSAL PRACTICES. See 25 Pa. Code § 78.61 for regulations.
- For disposal of residual waste and drill cuttings from below the surface casing seat, complete Section B. ALTERNATE WASTE DISPOSAL PRACTICES. See 25 Pa. Code § 78.62 or § 78.63 for regulations.
- For onsite pretreatment systems being used to treat frac flowback fluid for reuse/recycling or transportation to a permitted treatment/disposal facility, complete Sections A and C. See 25 PA Code 78.56; 78.61; 78.62 & 78.63 for regulations.

**A. PITS AND TANKS FOR TEMPORARY CONTAINMENT**

Complete this section if requesting approval of an alternative practice for temporary containment of polluttional substances and wastes from drilling, altering, or completing a well. See 25 Pa. Code § 78.56.

- a) Check the box below and fill in the dates the pit will be used if you are requesting a variance from the requirement that the bottom of the pit be at least 20 inches above the seasonal high groundwater table for a pit that exists only during dry times of the year and is located above groundwater. See 25 Pa. Code § 78.56(a)(4)(iii).  
 Variance requested; dates to be used, from \_\_\_\_\_ to \_\_\_\_\_
- b) Check the box below if you are requesting approval of an alternative practice for temporary containment.  
 Approval of an other alternative practice is requested. Describe the type of waste and the temporary containment method. Include information which will demonstrate that the proposed alternative practices will provide equivalent or superior protection to the practices identified in 25 Pa. Code § 78.56.



**B. ALTERNATIVE WASTE DISPOSAL PRACTICES**

Complete this section if requesting approval of an alternative practice to dispose of drill cuttings or residual wastes at the well site. Describe the type of waste, including any additives, and the proposed alternative practice. Include information that will demonstrate the proposed practice will provide protection equivalent or superior to the practices identified in 25 Pa. Code § 78.61, 78.62, or 78.63.

Scorpio Energy, LLC is requesting DEP approval for disposal of uncontaminated drill cuttings into a structurally sound and unlined drill pit.

Before the drill cuttings enter the pit, fresh water will be injected into the blooie line, eliminating dust. The pit will be located more than 100' from a stream or wetland and 200' from an existing building or water supply.

Hastings Run (CWF) lies +/-500' south of the clearing limits, there aren't any wetlands or buildings within 400' of the project.

The attached site plan depict well and pit location (depending upon soils, drainage and other conditions observed during construction) and any stream, wetland or building that may be within 250' of the well.

According to the Map Unit Description of Warren and Forest Counties, the soil at the well location is Cookport Silt Loam (CvC).

Historical records indicate fresh water will be encountered at a depth of +/- 400'.

A second pit will be utilized for fracing.

The pit will be backfilled, graded and seeded and mulched.

Ph and conductivity will be tested and reported according to regulations.

**C. ONSITE PRETREATMENT OF DRILLING FLUIDS OR FRAC FLOWBACK FLUID**

Complete this section if requesting approval of an onsite mobile pretreatment system for drilling fluids and/or frac flowback for recycling/reuse or transportation to a permitted treatment/disposal facility.

a) Check the appropriate box or boxes that best describe the planned treatment on site.

Use of chemicals or technologies not part of the original permitted well site or in the PPC plan.

Storage of drilling fluids or frac flowback for recycle/reuse.

Transportation of drilling fluids or frac flowback for recycle/reuse.

Disposal of the original waste stream and/or any new waste streams created through pretreatment at an approved permitted facility.

b) Provide a narrative description for all boxes checked above including pretreatment facility design and methodology (use additional pages if necessary)

c) Company/contractor for the onsite treatment facility including name, address, contact person and contact information.

d) Disposal location and permit number for all residual waste generated from the treatment process:

**SIGNATURE OF APPLICANT**

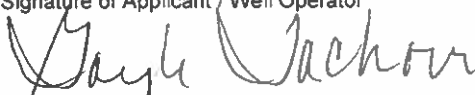
Signature of Applicant / Well Operator 	Print or Type Signer's Name and Title Gayle Tachoir, President	Date 10-8-25
---	---	-----------------

DEP USE ONLY		
<input type="checkbox"/> Approved <input checked="" type="checkbox"/> Denied DEP Representative: Brian Ayers	Conditions: <input type="checkbox"/> YES, see below or attached. <input type="checkbox"/> NO	Date 03.03.26
Conditions:  A site evaluation determined that this site is unsuited for the proposed Alternate Waste Management Practices. The operator may resubmit the Request for Approval of Alternate Waste Management Practices if they can demonstrate that shallow groundwater will not compromise the drill pit on this well site.		

**Instructions**

Use this form to apply for approval of alternative waste management practices under 25 Pa. Code § 78.56, 78.61, 78.62, or 78.63.

Complete this form and submit it with all other necessary documentation. Label each attachment with applicant's name and the information item it refers to.

Send your application to the Oil and Gas Management Program at the appropriate DEP regional office:

PA DEP  
 Oil & Gas Management Program  
 Northwest Regional Office  
 230 Chestnut Street  
 Meadville, PA 16335-3481  
 Phone: 814-332-6860  
 Fax: 814-332-6121

PA DEP  
 Oil & Gas Management Program  
 Southwest Regional Office  
 400 Waterfront Drive  
 Pittsburgh, PA 15222-4745  
 Phone: 412-442-4015  
 Fax: 412-442-4328

PA DEP  
 Oil & Gas Management Program  
 Northcentral Regional Office  
 208 West Third Street  
 Williamsport, PA 17701-6448  
 Phone: 570-321-6550  
 Fax: 570-327-3565



COMMONWEALTH OF PENNSYLVANIA  
DEPARTMENT OF ENVIRONMENTAL PROTECTION  
OFFICE OF OIL AND GAS MANAGEMENT  
**WELL LOCATION PLAT**

DEP	Auth ID #:	G:
USE	Permit #:	C:
ONLY	Project #:	

PAGE 1 Surface Location

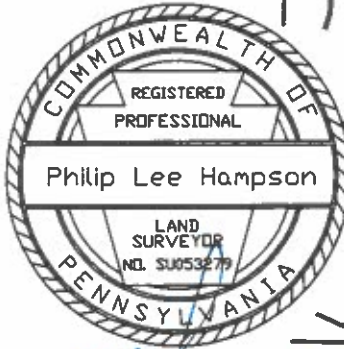
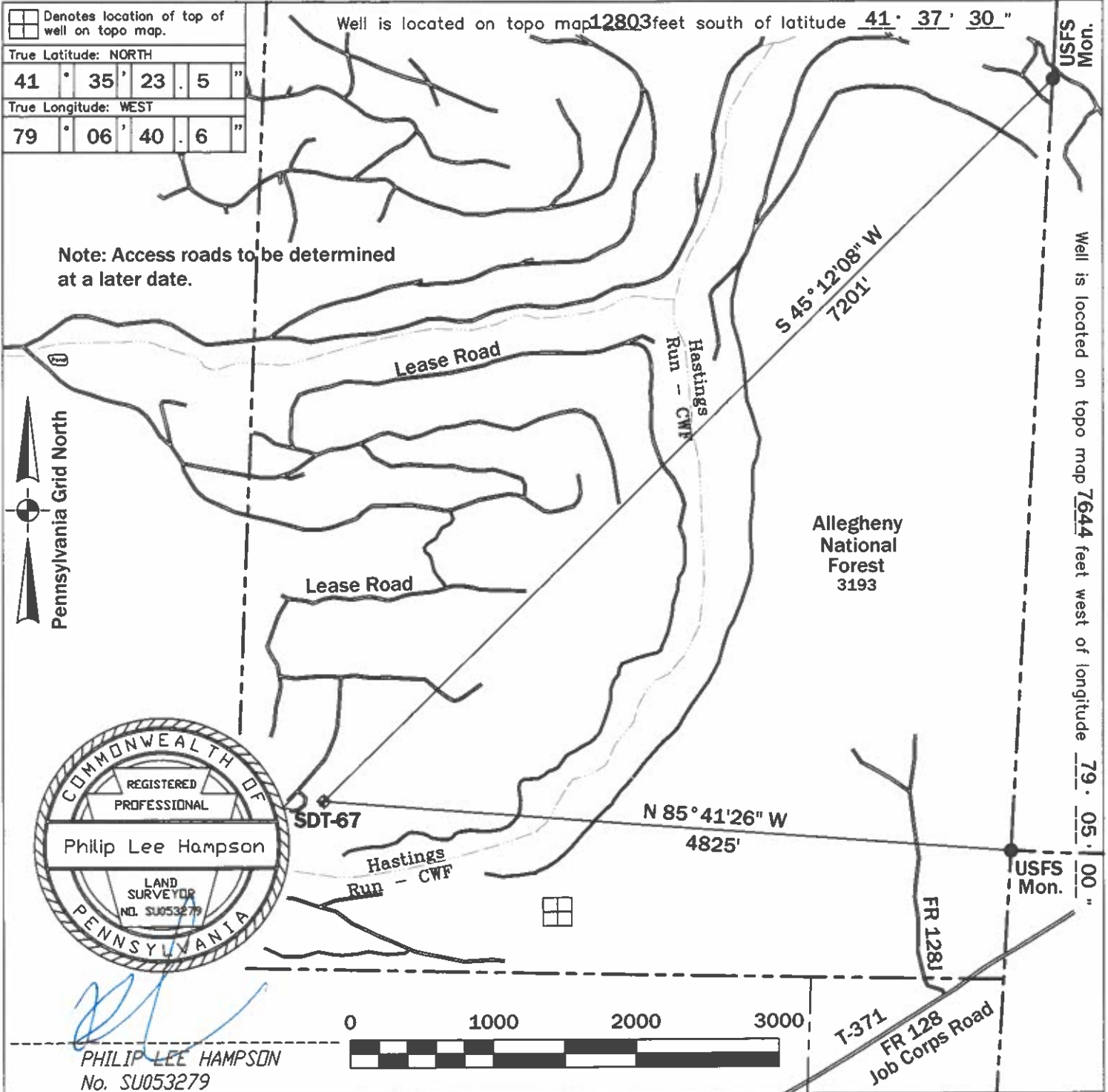

Applicant/Well Operator Name: Scorpio Energy, Inc.		DEP ID # 300597	Well (Farm) Name: Hastings		Well #: SDT-67	Serial #:
Address: 203 Center Street, Sheffield, PA 16347			County: Forest	Municipality: Howe Township	Well Type: Oil	
911 address of well site: N/A			USGS 7½' Quadrangle Map Name: Lynch - 613	Map Section: 1	Surface Elevation: 1768 ft.	
Surveyor or Engineer: Philip L. Hampson, PLS	Phone #: 814-730-1822	Dwg #: SDT-67	Date: 9/23/25	Scale: 1"=1000'	Tract Acreage: +/-950 Acres	
Lat. & Long Metadata Method: Direct GPS	Accuracy: +/-15' ft.	Datum: NAD 83	Elevation Metadata Method: Scaled LIDAR	Accuracy: ft.	Datum: NGVD 29	Survey Date: 9/19/25



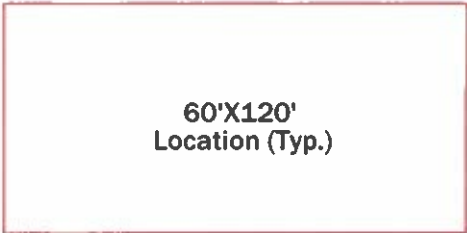
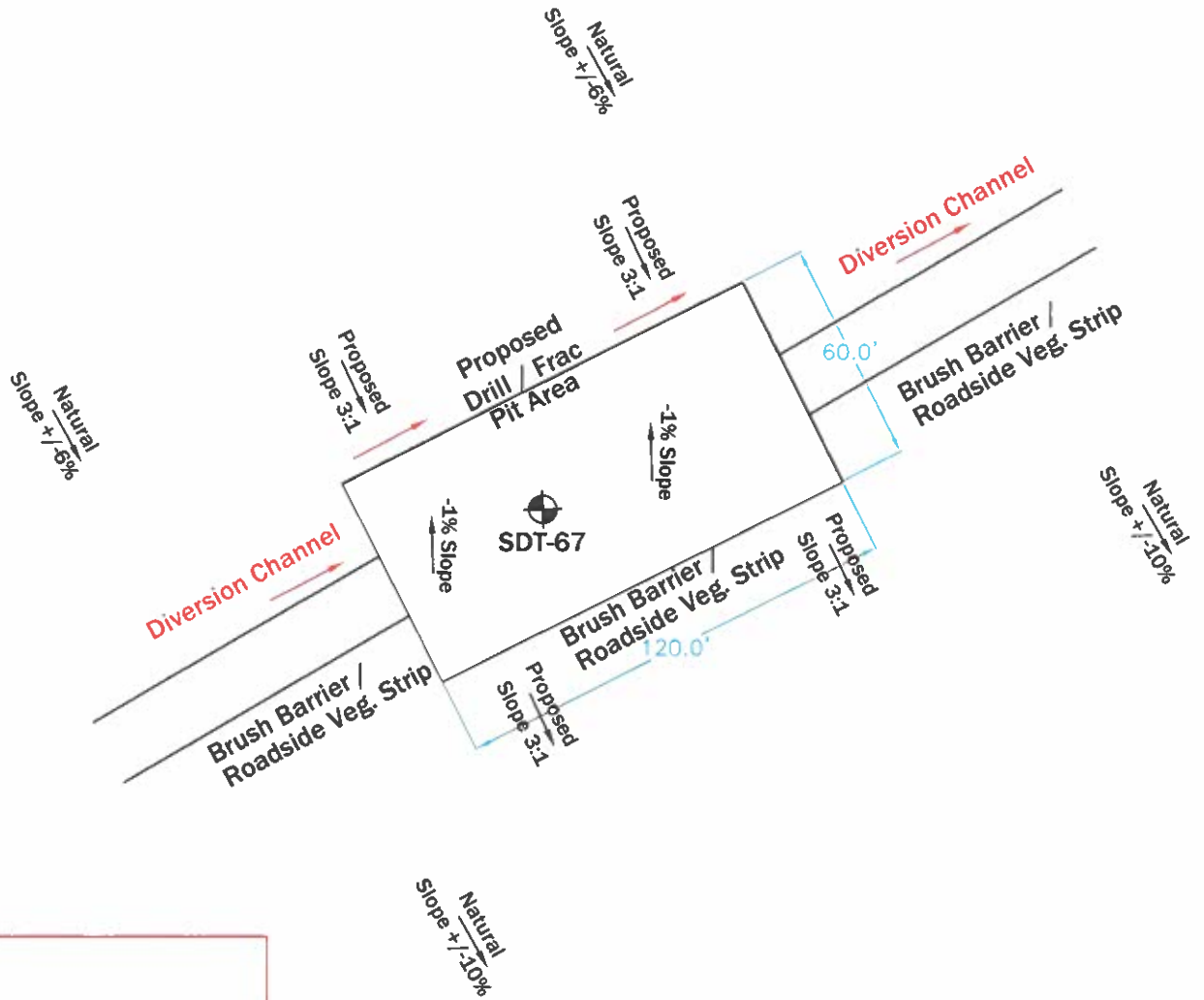

60'X120'  
Location (Typ.)



10'X15" Drill / Frac  
Pit (Typ.)

A minimum of 100' must be maintained  
between pits and mapped blue line streams.

Note: Diversion Channel must be plugged to  
prevent drill and frac fluids from leaving the site.

Note: Install energy dissipaters at the out fall  
of culverts where high flow may cause  
accelerated erosion.

Note: Use additional erosion and sediment  
control methods as described in the Erosion  
and Sediment Control Plan on an as needed  
basis.

Scale: Not to Scale

Date: 09/24/2025



105 Willoughby Avenue • Warren, PA 16365  
(814)730-1822 • hampson@westpa.net

Scorpio Energy, Inc. SDT-67

on

Warrant 3193

*Allegheny National Forest*

Howe Township, Forest County

Pennsylvania