

**From:** [Hogue, Kate](#)  
**To:** [Gayle Tachoir](#)  
**Cc:** [Ayers, Brian](#)  
**Subject:** Auth 1559685 053-31199, 053-31200, 053-31201, 053-31202, 053-31203, 053-31204, 053-31205, 053-31196, 053-31198, 053-31197  
**Date:** Tuesday, March 24, 2026 4:14:00 PM  
**Attachments:** [Auth 1559685 053-31199.pdf](#)  
[Auth 1559695 053-31200.pdf](#)  
[Auth 1559704 053-31201.pdf](#)  
[Auth 1559721 053-31202.pdf](#)  
[Auth 1559734 053-31203.pdf](#)  
[Auth 1559744 053-31204.pdf](#)  
[Auth 1559763 053-31205.pdf](#)  
[Auth 1559625 053-31196 .pdf](#)  
[Auth 1559639 053-31198.pdf](#)  
[Auth 1559674 053-31197.pdf](#)  
[053-31202 AWM.pdf](#)  
[053-31203 AWM denied 03.03.26.pdf](#)  
[053-31204 AWM denied 03.03.26.pdf](#)  
[053-31205 AWM denied 03.03.26.pdf](#)  
[053-31196 AWM.pdf](#)  
[053-31197 AWM denied 03.03.26.pdf](#)  
[053-31198 AWM denied 03.03.26.pdf](#)  
[053-31199 AWM denied 03.03.26.pdf](#)  
[053-31200 AWM.pdf](#)  
[053-31201 AWM.pdf](#)  
[Well Permit Cover Letter \(conventional\) 1-12-23.pdf](#)

---

**Operator,**

The Department of Environmental Protection has completed the review of the applications corresponding to the attached permits.

The department hereby approves the permits to drill and operate the wells pursuant to applicable laws and regulations for this activity and to specific conditions of the individual permits.

The cover letter for these permits is also attached.

This information can also be viewed on our website, at the Oil and Gas Mapping tool: <https://www.depgis.state.pa.us/PaOilAndGasMapping/>

Thanks,  
Kate

Kate Hogue | Clerical Supervisor II  
Department of Environmental Protection | Bureau of Oil and Gas Management  
230 Chestnut Street | Meadville PA 16335  
Phone: 814.332.6868

[www.dep.pa.gov](http://www.dep.pa.gov)



**COMMONWEALTH OF PENNSYLVANIA  
DEPARTMENT OF ENVIRONMENTAL PROTECTION  
OIL AND GAS MANAGEMENT PROGRAM**

DEP USE ONLY	
Permittee's eFACTS ID <b>300597</b>	Auth ID <b>1559763</b>
Watershed Name	Quality

## WELL PERMIT

Permittee <b>SCORPIO ENERGY INC</b>	OGO.# <b>OGO-68500</b>	Permit Number <b>37-053-31205-00-00</b>	Date Issued <b>03/23/2026</b>
Address <b>203 CENTER ST</b>		Farm Name & Well Number <b>HASTINGS SDT 69</b>	Well Serial #
Municipality <b>Howe Twp</b>		County <b>Forest</b>	
SHEFFIELD, PA 16347		7½' Quadrangle Name <b>Lynch</b>	Map Section # <b>1</b>
Phone <b>(814) 727-7717</b>	Project #	Latitude <b>41-35-25.1000</b>	Longitude <b>-79-6-30.5000</b>
Surf Elev at Site <b>1736 feet</b>	Anticipated Maximum TVD <b>2000 feet</b>	Well Type <b>OL</b>	Offset distances referenced to NE corner of map section. <b>South 12641 feet West 6877 feet</b>

This permit covering the well operator and well location shown above is evidence of permission granted to conduct activities in accordance with the Oil and Gas Act and the Oil and Gas Conservation Law, if the well is subject to that act and any rules and regulations promulgated thereunder, subject to the conditions contained herein and in accordance with the application submitted for this permit. This permit does not convey any property rights.

This permit and the permittee's authority to conduct the activities authorized by this permit are conditioned upon operator's compliance with applicable law and regulations.

Notification must be given to the district oil and gas inspector, the surface landowner and political subdivision of the date well drilling will begin at least 24 hours prior to commencement of drilling activities.

The permittee hereby authorizes and consents to allow, without delay, employees or agents of the Department to have access to and to inspect all areas upon presentation of appropriate credentials, without advance notice or a search warrant. This includes any property, facility, operation or activity governed by the Oil and Gas Act, the Oil and Gas Conservation Law, the Coal and Gas Resource Coordination Act and other statutes applicable to oil and gas activities administered by the Department. The authorization and consent shall include consent to the Department to collect samples of wastewaters or gases, to take photographs, to perform measurements, surveys, and other tests, to inspect any monitoring equipment, to inspect the methods of operation and disposal, and to inspect and copy documents required by the Department to be maintained. The authorization and consent includes consent to the Department to examine books, papers, and records pertinent to any matter under investigation pursuant to the Oil and Gas Act or pertinent to a determination of whether the operator is in compliance with the above referenced statutes. This condition in no way limits any other powers granted to the Department under the Oil and Gas Act and other statutes, rules and regulations applicable to these activities as administered by the Department.

This permit does not relieve the operator from the obligation to comply with the Clean Streams Law and all statutes, rules and regulations administered by the Department.

### Special Permit Conditions:

- 1) This permit is conditioned upon the well operator obtaining all appropriate approvals, including local, municipal, and zoning approvals, and any revision or modification of those approvals.
- 2) Contact the Inspector at least 24 hours prior to commencing any frac/stimulation procedures.
- 3) The operator shall provide notice to the appropriate Department Water Quality Specialist (WQS) & WQS Supervisor at least 3 business days prior to excavating a pit at this location.
- 4) Ensure that pits used for disposal of residual waste are located at least 100 feet from all streams, bodies of water and wetlands as referenced in §78.62(a)(6).
- 5) U.S. Fish and Wildlife Service Avoidance Measure: The proposed project is located in the vicinity of northern long-eared bat summer occupancy habitat. To ensure take is not reasonably certain to occur, do not conduct tree removal from April 1 to September 30.

This permit expires **03/23/2027** unless drilling is commenced on or before that date and prosecuted with due diligence.

Thomas Donohue                      3/23/26  
Subsurface Permits Environmental Program Manager

ERIC WYMER

310 BEST AVE  
KNOX, PA 16232

814-573-3588

Oil & Gas Inspector

Address

Phone Number



**PERMIT APPLICATION TO DRILL AND OPERATE A CONVENTIONAL WELL**

		DEP USE ONLY	
Notes <i>NC AWM</i> <i>✓ #13803 - \$4,000</i> <i>APPS</i> <i>PNOI - 9-25-25</i>	OGO #	68500	Objection Date - Do not issue before: 02/19/2026
	Client Id	300597	Date Approved: SGP 3/20/2026
	Bond #	13425	Special Cond. <b>FRAC/STIM 24; BAT; WQS (see eWell)</b>
	C: 022326 bgr G: 03/18/2026 BEH		
INV:	APS #	Auth Id	Site Id
	1156828	1559763	886349
			PF Id 890267 SF Id 1469956

Please read instructions before you begin filling in this form.

WELL INFORMATION							
Well Operator Scorpio Energy, Inc.	DEP ID# 300597	Well API # 37-053-31205-	Well Farm Name Hastings	Well # SDT-69			
Address 203 Center Street		LAT 41°35' 25.1-	NAD 83	Project Number	Serial #		
		LONG - 79°6' 30.5-					
City Sheffield	State PA	Zip 16347	Municipality Name/ City, Borough, Township Howe Township	County Forest County			
Phone 814-727-7717	Fax 814-727-7718	Email		USGS 7.5 min. quadrangle map Lynch - 613	Section 1		

<input type="checkbox"/> Check if this is a new address	24/7 Emergency Phone contact number 814-688-0388	911 address of well site (if available)
---	---	---

Freshwater Impoundment Name/ Identification	Centralized Impoundment Name/ Identification	Well Pad Name/Identification	Borrow Area Name/Identification
--	---	------------------------------	---------------------------------

Surface Elev 1736	Deepest Formation to be penetrated: Cooper	Anticipated TVD 2000	<b>PERMIT TYPE</b> Check applicable. Application is to: <input checked="" type="checkbox"/> Drill a new <input type="checkbox"/> Re-permit expired permit <input type="checkbox"/> Deepen well <input type="checkbox"/> Redrill wellbore <input type="checkbox"/> Alter well <input type="checkbox"/> Other (specify)	<b>TYPE OF WELL</b> Check applicable. <input type="checkbox"/> Gas <input checked="" type="checkbox"/> Oil <input type="checkbox"/> Comb. (gas & oil/condensate) <input type="checkbox"/> Injection, recovery <input type="checkbox"/> Injection, disposal <input type="checkbox"/> Coalbed Methane <input type="checkbox"/> Gas Storage <input type="checkbox"/> Other (specify)	<b>APPLICATION FEE</b> Check applicable. <input checked="" type="checkbox"/> Conventional <input type="checkbox"/> \$200 (Home Use Well) <b>Total Application Fee \$ 400.00</b>  Bond Agreement Id NWSB #2123016798
Target Formation(s) proposed for production Cooper	Anticipated Target Top/Bottom TVD 1970' 2000'	Number of wellbore laterals proposed under this application 0			
Total feet of wellbore to be drilled under this application 2000 Ft.			<div style="border: 1px solid black; padding: 5px; display: inline-block;"> <b>RECEIVED</b>   <b>FEB 19 2026</b>                       Environmental Protection                      Northwest Regional Office                 </div>		
If applying for a permit to rework an existing well not registered or permitted, check this box <input type="checkbox"/> and enter date drilled, if known: _____ (see instructions)					
<b>PNDI Attached:</b> <input checked="" type="checkbox"/> Any threatened or endangered "hit" must include a copy of the clearance letter from the applicable agency(ies).			Configuration <input checked="" type="checkbox"/> Vertical <input type="checkbox"/> Horizontal <input type="checkbox"/> Deviated <input type="checkbox"/> Multiple laterals		
Application submitted as: Coal well: <input type="checkbox"/> Attach Coal Module CBM well <input type="checkbox"/> Attach Coal Module Non coal well <input checked="" type="checkbox"/> Attach justification.			Please see attached Map 11 or Map 61		

COORDINATION WITH REGULATIONS AND OTHER PERMITS	Yes	No
1. Will the well be subject to the Oil and Gas Conservation Law? If "No," go to 2).	<input type="checkbox"/>	<input checked="" type="checkbox"/>
a. If "Yes" to #1, is the well at least 330 feet from outside lease or unit boundary?	<input type="checkbox"/>	<input type="checkbox"/>
b. Does the location fall within an area covered by a spacing order?	<input type="checkbox"/>	<input type="checkbox"/>
c. If the well will be multilateral, identify the wellbores on the sketch on page 3 of the plat that will be completed as conservation and non-conservation.		
2. Will the edge of the disturbed area of any portion of the well site of a conventional well be within 100 feet from the edge of any solid blue lined stream, spring or body of water identified on the most current 7½' topographic quadrangle map or wetland greater than one acre in size or in a wetland?	<input type="checkbox"/>	<input checked="" type="checkbox"/>
If yes, is a waiver request (form 5500-FM-OG0057) and site-specific E&S control plan attached?	<input type="checkbox"/>	<input type="checkbox"/>



DEP	Auth ID #1559763	3/18/26
USE	Permit # 053-31205	G: BEH
ONLY	Project #:	C:



WELL LOCATION PLAT

PAGE 1 Surface Location

Type text here

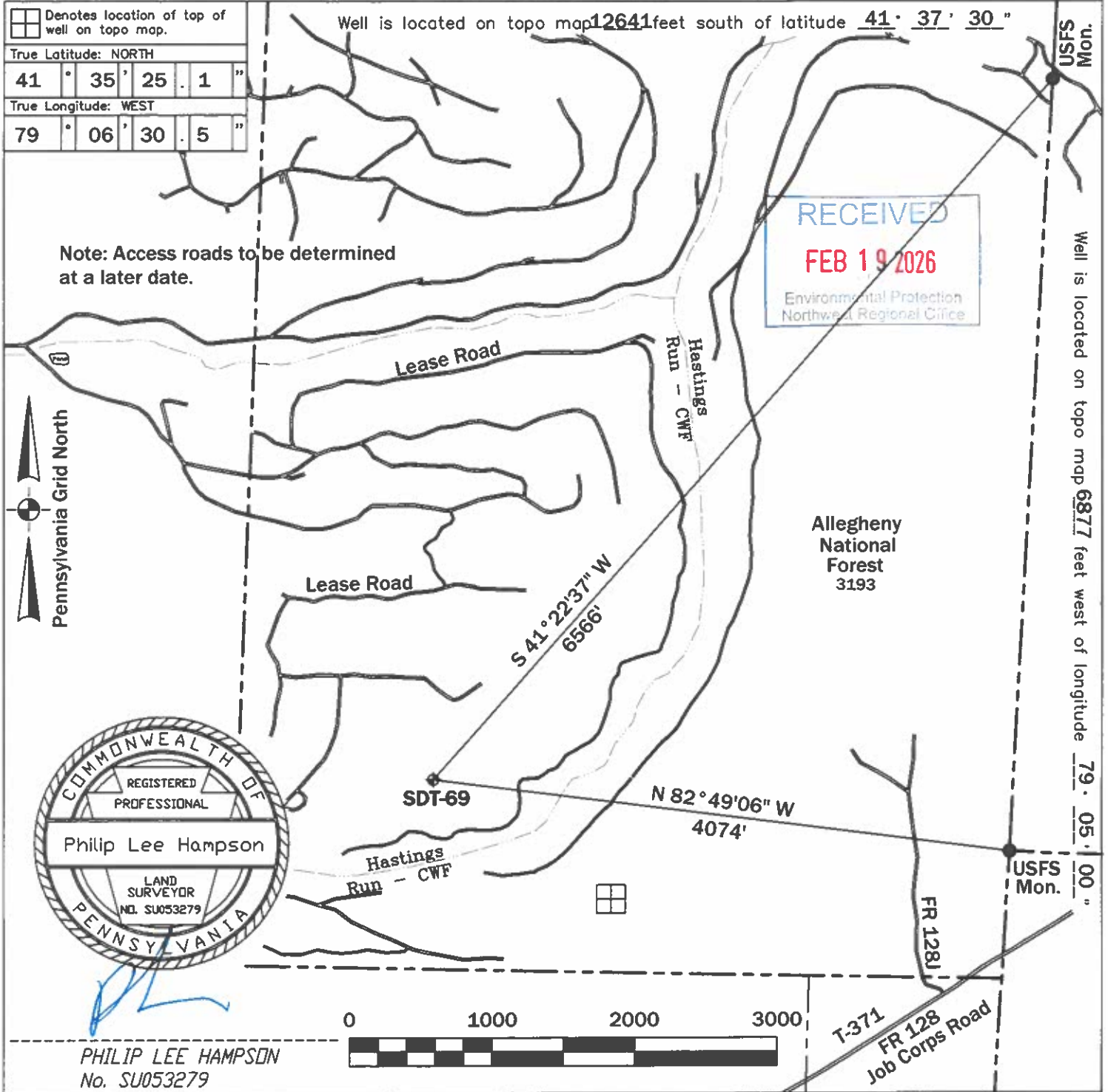

PHILIP LEE HAMPSON  
No. SU053279

Applicant/Well Operator Name: Scorpio Energy, Inc.		DEP ID # 300597	Well (Farm) Name: Hastings		Well # SDT-69	Serial #:
Address: 203 Center Street, Sheffield, PA 16347			County: Forest	Municipality: Howe Township	Well Type: Oil	
911 address of well site: N/A			USGS 7½' Quadrangle Map Name: Lynch - 613	Map Section: 1	Surface Elevation: 1736 ft.	
Surveyor or Engineer: Philip L. Hampson, PLS	Phone #: 814-730-1822	Dwg #: SDT-69	Date: 9/23/25	Scale: 1"=1000'	Tract Acreage: +/-950 Acres	
Lat. & Long Metadata Method: Direct GPS		Accuracy: +/-15' ft.	Datum: NAD 83	Elevation Metadata Method: Scaled LIDAR	Datum: NGVD 29	Survey Date: 9/19/25





**PERMIT APPLICATION TO DRILL AND OPERATE  
A CONVENTIONAL WELL  
Record of Notification**

Farm Name - Well # Hastings / SDT-69	
Applicant Name Scorpio Energy, Inc.	DEP ID# 300597
<b>DEP USE ONLY</b>	APS #

List the following: surface landowner; surface landowners and water purveyors with water supplies within 1000 feet; municipality where the well will be drilled; adjacent municipality; gas storage operator if within 2000 feet. Mark the boxes, "X," which show the parties' interests. Use additional forms if you need more space. You are required to notify each of these parties. <b>Notification: Signature below name indicates the party's acknowledgement of receipt of the well location plat and serves as proof of notification</b>		Surface Landowner	Gas Storage Operator	Surface Landowners & Water Purveyors with water supplies <1000'	Municipalities	Notification Note the means and attach proof.			
						Certified Mail Dates		Address Affidavit	Written Consent
						Sent	Return Receipt		
Print Name: Allegheny National Forest Signature	Address: 4 Farm Colony Drive Warren, PA 16365	X				9/25/25	9/29/25		
Print Name: Howe Township Signature	Address: 7947 Route 666 Sheffield, PA 16347				X	9/25/25	9/30/25		
Print Name: Cherry Grove Township Signature	Address: 6039 Cherry Grove Road Clarendon, PA 16313				X	9/25/25	9/30/25		
Print Name: Sheffield Township Signature	Address: P.O. Box 784 Sheffield, PA 16347				X	9/25/25	9/29/25		
Print Name: Wetmore Township Signature	Address: 318 Spring Street Kane, PA 16735				X	9/25/25	10/3/25		

**Record of Written Consent**

**Written Consent: Signature below indicates the party's approval of the well location, or indicates written consent and waives the 15-day objection period where applicable.**  
Check applicable box

Print and Sign Name:	Address:	Date:	Surface Owner	Water Well within 200 feet	Building within 200 feet
			<input type="checkbox"/>	<input type="checkbox"/>	<input type="checkbox"/>
			<input type="checkbox"/>	<input type="checkbox"/>	<input type="checkbox"/>
			<input type="checkbox"/>	<input type="checkbox"/>	<input type="checkbox"/>
			<input type="checkbox"/>	<input type="checkbox"/>	<input type="checkbox"/>
			<input type="checkbox"/>	<input type="checkbox"/>	<input type="checkbox"/>

Type text here

## PERMIT APPLICATION TO DRILL AND OPERATE A CONVENTIONAL WELL Record of Notification

Farm Name - Well # Hastings / SDT-69	
Applicant Name Scorpio Energy, Inc.	DEP ID# 300597
<b>DEP USE ONLY</b>	APS #

List the following: surface landowner; surface landowners and water purveyors with water supplies within 1000 feet; municipality where the well will be drilled; adjacent municipality; gas storage operator if within 2000 feet. Mark the boxes, "X," which show the parties' interests. Use additional forms if you need more space. You are required to notify each of these parties. <b>Notification: Signature below name indicates the party's acknowledgement of receipt of the well location plat and serves as proof of notification</b>		Surface Landowner	Gas Storage Operator	Surface Landowners & Water Purveyors with water supplies <1000'	Municipalities	Notification Note the means and attach proof.			
						Certified Mail Dates		Address Affidavit	Written Consent
						Sent	Return Receipt		
Print Name: Highland Township	Address: P.O. Box 505 James City, PA 16734				X	9/25/25	9/29/25		
Signature									
Print Name: Jenks Township	Address: P.O. Box 436 Marienville, PA 16239				X	9/25/25	9/29/25		
Signature									
Print Name: Kingsley Township	Address: P.O. Box 339 Marienville, PA 16239				X	9/25/25	10/2/25		
Signature									
Print Name: Watson Township	Address: 2011 Route 337 Tidioute, PA 16351				X	9/25/25	10/4/25		
Signature									
Print Name:	Address:								
Signature									

### Record of Written Consent

**Written Consent: Signature below indicates the party's approval of the well location, or indicates written consent and waives the 15-day objection period where applicable.**  
Check applicable box

			Surface Owner	Water Well within 200 feet	Building within 200 feet
Print and Sign Name:	Address:	Date:	<input type="checkbox"/>	<input type="checkbox"/>	<input type="checkbox"/>
Print and Sign Name:	Address:	Date:	<input type="checkbox"/>	<input type="checkbox"/>	<input type="checkbox"/>
Print and Sign Name:	Address:	Date:	<input type="checkbox"/>	<input type="checkbox"/>	<input type="checkbox"/>
Print and Sign Name:	Address:	Date:	<input type="checkbox"/>	<input type="checkbox"/>	<input type="checkbox"/>
Print and Sign Name:	Address:	Date:	<input type="checkbox"/>	<input type="checkbox"/>	<input type="checkbox"/>

**SENDER: COMPLETE THIS SECTION**

- Complete items 1, 2, and 3.
- Print your name and address on the reverse so that we can return the card to you.
- Attach this card to the back of the mailpiece, or on the front if space permits.

1. Article Addressed to:  
**Howe Township**  
**7947 Route 666**  
**Sheffield, PA 16347**



2. Article Number (Transfer from service label)  
**9589 0710 5270 2101 7607 67**

PS Form 3811, July 2020 PSN 7530-02-000-9053

**COMPLETE THIS SECTION ON DELIVERY**

A. Signature  
 X *Beverly Pollock*  Agent  Addressee

B. Received by (Printed Name)  
*Beverly Pollock*

C. Date of Delivery  
*9-30-25*

D. Is delivery address different from item 1?  Yes  
 If YES, enter delivery address below:  No

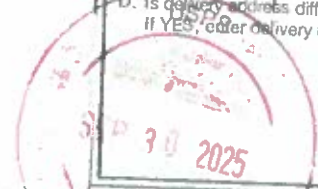

3. Service Type  
 Adult Signature  Priority Mail Express®  
 Adult Signature Restricted Delivery  Registered Mail™  
 Certified Mail®  Registered Mail Restricted Delivery  
 Certified Mail Restricted Delivery  Signature Confirmation™  
 Collect on Delivery  Signature Confirmation Restricted Delivery  
 Collect on Delivery Restricted Delivery

Domestic Return Receipt

**COMPLETE THIS SECTION ON DELIVERY**

A. Signature  
 X *[Signature]*  Agent  Addressee

B. Received by (Printed Name)  
*[Name]*

C. Date of Delivery  
*9-26*

D. Is delivery address different from item 1?  Yes  
 If YES, enter delivery address below:  No

3. Service Type  
 Priority Mail Express®  
 Registered Mail™  
 Registered Mail Restricted Delivery  
 Certified Mail®  
 Certified Mail Restricted Delivery  
 Signature Confirmation™  
 Signature Confirmation Restricted Delivery  
 Collect on Delivery  
 Collect on Delivery Restricted Delivery

2. Article Number (Transfer from service label)  
**9589 0710 5270 2101 7607 74**

PS Form 3811, July 2020 PSN 7530-02-000-9053

Domestic Return Receipt

**SENDER: COMPLETE THIS SECTION**

- Complete items 1, 2, and 3.
- Print your name and address on the reverse so that we can return the card to you.
- Attach this card to the back of the mailpiece, or on the front if space permits.

1. **Allegheny National Forest**  
**4 Farm Colony Drive**  
**Warren, PA 16365**



2. **9589 0710 5270 2101 7608 42**

PS Form 3811, July 2020 PSN 7530-02-000-9053

**COMPLETE THIS SECTION ON DELIVERY**

A. Signature  
 X *J. Bantelle*  Agent  Addressee

B. Received by (Printed Name)  
*Lydian Bantelle*

C. Date of Delivery  
*9/29/25*

D. Is delivery address different from item 1?  Yes  
 If YES, enter delivery address below:  No

3. Service Type  
 Adult Signature  Priority Mail Express®  
 Adult Signature Restricted Delivery  Registered Mail™  
 Certified Mail®  Registered Mail Restricted Delivery  
 Certified Mail Restricted Delivery  Signature Confirmation™  
 Collect on Delivery  Signature Confirmation Restricted Delivery  
 Collect on Delivery Restricted Delivery

Domestic Return Receipt (over \$500)

Domestic Return Receipt

**SENDER: COMPLETE THIS SECTION**

- Complete items 1, 2, and 3.
- Print your name and address on the reverse so that we can return the card to you.
- Attach this card to the back of the mailpiece, or on the front if space permits.

1. Article Addressed to:  
**Cherry Grove Township**  
**6039 Cherry Grove Road**  
**Clarendon, PA 16313**



2. Article Number (Transfer from service label)  
**9589 0710 5270 2101 7607 74**

PS Form 3811, July 2020 PSN 7530-02-000-9053

Domestic Return Receipt

**SENDER: COMPLETE THIS SECTION**

- Complete items 1, 2, and 3.
- Print your name and address on the reverse so that we can return the card to you.
- Attach this card to the back of the mailpiece, or on the front if space permits.

1. Article Addressed to:

Highland Township  
P.O. Box 505  
James City, PA 16734



9590 9402 9634 5121 4557 62

2. Article Number (Transfer from service label)

9589 0710 5270 2101 7608 04

Restricted Delivery

PS Form 3811, July 2020 PSN 7530-02-000-9053

Domestic Return Receipt

**COMPLETE THIS SECTION ON DELIVERY**

A. Signature

*Carrie Dempsey*  Agent  Addressee

B. Received by (Printed Name)

*Carrie Dempsey*

C. Date of Delivery

*9-29-25*

D. Is delivery address different from item 1?  Yes  
If YES, enter delivery address below:  No

3. Service Type

- Adult Signature
- Adult Signature Restricted Delivery
- Certified Mail®
- Certified Mail Restricted Delivery
- Collect on Delivery
- Collect on Delivery Restricted Delivery
- Priority Mail Express®
- Registered Mail™
- Registered Mail Restricted Delivery
- Signature Confirmation™
- Signature Confirmation Restricted Delivery

**SENDER: COMPLETE THIS SECTION**

- Complete items 1, 2, and 3.
- Print your name and address on the reverse so that we can return the card to you.
- Attach this card to the back of the mailpiece, or on the front if space permits.

1. Article Addressed to:

Sheffield Township  
P.O. Box 784  
Sheffield, PA 16347



9590 9402 9634 5121 4557 48

2. Article Number (Transfer from service label)

9589 0710 5270 2101 7607 81

Restricted Delivery

PS Form 3811, July 2020 PSN 7530-02-000-9053

Domestic Return Receipt

**COMPLETE THIS SECTION ON DELIVERY**

A. Signature

*Cara Schrader*  Agent  Addressee

B. Received by (Printed Name)

*Cara Schrader*

C. Date of Delivery

*9/29/25*

D. Is delivery address different from item 1?  Yes  
If YES, enter delivery address below:  No

3. Service Type

- Adult Signature
- Adult Signature Restricted Delivery
- Certified Mail®
- Certified Mail Restricted Delivery
- Collect on Delivery
- Collect on Delivery Restricted Delivery
- Priority Mail Express®
- Registered Mail™
- Registered Mail Restricted Delivery
- Signature Confirmation™
- Signature Confirmation Restricted Delivery

**COMPLETE THIS SECTION ON DELIVERY**

A. Signature  Agent  Addressee

*Mr. [Signature]*

B. Received by (Printed Name)  Date of Delivery

*Mr. [Signature]* *9/29*

D. Is delivery address different from item 1?  Yes  
If YES, enter delivery address below:  No

**SENDER: COMPLETE THIS SECTION**

- Complete items 1, 2, and 3.
- Print your name and address on the reverse so that we can return the card to you.
- Attach this card to the back of the mailpiece, or on the front if space permits.

1. Article Addressed to:

Jenks Township  
P.O. Box 436  
Marienville, PA 16239



9590 9402 9634 5121 4557 79

2. Article Number (Transfer from service label)

9589 0710 5270 2101 7608 11

PS Form 3811, July 2020 PSN 7530-02-000-9053

Domestic Return Receipt

- Priority Mail Express®
- Registered Mail™
- Registered Mail Restricted Delivery
- Certified Mail®
- Certified Mail Restricted Delivery
- Collect on Delivery
- Collect on Delivery Restricted Delivery
- Insured Mail
- Priority Mail Express®
- Registered Mail™
- Registered Mail Restricted Delivery
- Signature Confirmation™
- Signature Confirmation Restricted Delivery

**SENDER: COMPLETE THIS SECTION**

- Complete items 1, 2, and 3.
- Print your name and address on the reverse so that we can return the card to you.
- Attach this card to the back of the mailpiece, or on the front if space permits.

1. Article Addressed to:

**Kingsley Township  
P.O. Box 339  
Marienville, PA 16239**



9590 9402 9634 5121 4557 86

2. Article Number (Transfer from service label)

9589 0710 5270 2101 7608 28

PS Form 3811, July 2020 PSN 7530-02-000-9053

**COMPLETE THIS SECTION ON DELIVERY**

A. Signature

X *Dan Zimmer*  Agent  
 Addressee

B. Received by (Printed Name) C. Date of Delivery

*Dan Zimmer* *10/25*

D. Is delivery address different from item 1?  Yes  
 If YES, enter delivery address below:  No

3. Service Type
- |  |   |
|--|---|
| <input type="checkbox"/> Adult Signature                         | <input type="checkbox"/> Priority Mail Express®                     |
| <input type="checkbox"/> Adult Signature Restricted Delivery     | <input type="checkbox"/> Registered Mail™                           |
| <input checked="" type="checkbox"/> Certified Mail®              | <input type="checkbox"/> Registered Mail Restricted Delivery        |
| <input type="checkbox"/> Certified Mail Restricted Delivery      | <input type="checkbox"/> Signature Confirmation™                    |
| <input type="checkbox"/> Collect on Delivery                     | <input type="checkbox"/> Signature Confirmation Restricted Delivery |
| <input type="checkbox"/> Collect on Delivery Restricted Delivery |   |

**SENDER: COMPLETE THIS SECTION**

- Complete items 1, 2, and 3.
- Print your name and address on the reverse so that we can return the card to you.
- Attach this card to the back of the mailpiece, or on the front if space permits.

1. Article Addressed to:

**Watson Township  
2011 Route 337  
Tidioute, PA 16351**



9590 9402 9634 5121 4557 93

2. Article Number (Transfer from service label)

9589 0710 5270 2101 7608 35

PS Form 3811, July 2020 PSN 7530-02-000-9053

**COMPLETE THIS SECTION ON DELIVERY**

A. Signature

X *Michelle Spencer* **4 OCT 20**  
 Agent  
 Addressee

B. Received by (Printed Name) C. Date of Delivery

*Michelle Spencer* *10/4*

D. Is delivery address different from item 1?  Yes  
 If YES, enter delivery address below:  No

3. Service Type
- |  |   |
|--|---|
| <input type="checkbox"/> Adult Signature                         | <input type="checkbox"/> Priority Mail Express®                     |
| <input type="checkbox"/> Adult Signature Restricted Delivery     | <input type="checkbox"/> Registered Mail™                           |
| <input checked="" type="checkbox"/> Certified Mail®              | <input type="checkbox"/> Registered Mail Restricted Delivery        |
| <input type="checkbox"/> Certified Mail Restricted Delivery      | <input type="checkbox"/> Signature Confirmation™                    |
| <input type="checkbox"/> Collect on Delivery                     | <input type="checkbox"/> Signature Confirmation Restricted Delivery |
| <input type="checkbox"/> Collect on Delivery Restricted Delivery |   |

Domestic Return Receipt

Wetmore Township  
318 Spring Street  
Kane, PA 16735

Tracking Number:

**9589071052702101760798**

Remove X

Copy

Add to Informed Delivery (<https://informedelivery.usps.com/>)

## Latest Update

Your item was picked up at the post office at 11:40 am on October 3, 2025 in KANE, PA 16735.

Get More Out of USPS Tracking:

USPS Tracking Plus®

## Delivered

Delivered, Individual Picked Up at Post Office

KANE, PA 16735

October 3, 2025, 11:40 am

[See All Tracking History](#)

[What Do USPS Tracking Statuses Mean? \(https://faq.usps](https://faq.usps)

Text & Email Updates

USPS Tracking Plus®

Product Information

See Less ^

Track Another Package

Enter tracking or barcode numbers

9589 0710 5270 2101 7607 98

U.S. Postal Service™ CERTIFIED MAIL® RECEIPT Domestic Mail Only	
For delivery information, visit our website at <a href="http://www.usps.com">www.usps.com</a>	
Kane PA 16735	
Certified Mail Fee	\$5.30
Extra Services & Fees (check box, add fee as appropriate)	\$6.40
<input type="checkbox"/> Return Receipt (hardcopy)	\$1.00
<input type="checkbox"/> Return Receipt (electronic)	\$0.00
<input type="checkbox"/> Certified Mail Restricted Delivery	\$0.00
<input type="checkbox"/> Adult Signature Required	\$0.00
<input type="checkbox"/> Adult Signature Restricted Delivery	\$0.00
Postage	\$3.00
Total Postage and Fees	\$12.70
Sent To	WETMORE
Street and Apt. No., or PO Box No.	5 10/3
City, State, ZIP+4®	
PS Form 3800, January 2023 PSN 7530-02-000-9001 See Reverse for Instructions	

0385  
9  
Postmark  
Here  
09/25/2025



DEP USE ONLY	
APS #	Site #
Permit #	Auth ID #

### Coordination of a Well Location with Public Resources

Well Operator Scorpio Energy, Inc.		DEP ID# 300579	Well Farm Name and Number Hastings		SDT-69
Address 203 Center Street			Project Number (if previously assigned)		
City Sheffield	State PA	Zip Code 16347	County Forest	Municipality Howe Township	
Phone 814-727-7717	Fax 814-727-7718	Latitude N 41° 35' 25.1"		Longitude W 79° 06' 30.5"	
1. Will the well be located in or within 200 feet of a publicly owned park, forest, gameland, designated wildlife area or Natural National Landmark? <input checked="" type="checkbox"/> Yes <input type="checkbox"/> No					
2. Will the well be located within the corridor of a state or national scenic river? <input type="checkbox"/> Yes <input checked="" type="checkbox"/> No					
<p>Portions of the Allegheny River and Clarion River are currently on the National Wild and Scenic Rivers list. Detailed descriptions are available on the National Scenic Rivers website: <a href="http://www.nps.gov/rivers/wildriverslist.html#pa">www.nps.gov/rivers/wildriverslist.html#pa</a></p> <p>Portions of three other creeks and streams in oil and gas producing areas are currently listed as Pennsylvania Scenic Rivers. These are: Pine Creek in Tioga County, Lick Run in Clinton County, and Bear Creek in Fayette County. The streams corridor maps are available on DCNR's web site: <a href="http://www.dcnr.state.pa.us/brc/rivers/scenicrivers/locationmap.htm">www.dcnr.state.pa.us/brc/rivers/scenicrivers/locationmap.htm</a></p>					
3. If answering "Yes" to questions 1 or 2, name the public resource(s):					
Allegheny National Forest					
List the name, address and phone number of the person responsible for management of the public resource.					
Mitch Dysinger, 4 Farm Colony Drive, Warren, PA 16365 814-723-5150					
Must the administrator of the public resource approve or otherwise authorize the proposed well, well site, access road, or gathering pipeline? <input checked="" type="checkbox"/> Yes <input type="checkbox"/> No					
Has the approval or authorization been received? <input checked="" type="checkbox"/> Yes <input type="checkbox"/> No					
4. Has the search of the proposed well location against the Pennsylvania Natural Diversity Inventory (PNDI), or any other evaluation, identified a potential conflict with a species of special concern? <input checked="" type="checkbox"/> Yes <input type="checkbox"/> No					
If yes, provide PNDI Search Number _____ or attach a copy of the PNDI Search Results.					
If a potential conflict with a species of concern was identified, give the name of the responsible agency.					
US Fish and Wildlife Service					
Has the potential conflict been resolved? <input checked="" type="checkbox"/> Yes <input type="checkbox"/> No					
5. Will the well be located within 200 feet of any historical or archaeological sites listed as federal or state historic places? <input type="checkbox"/> Yes <input checked="" type="checkbox"/> No					
6. Describe in detail the additional measures, facilities, or practices specific to this site to be employed during site construction, drilling and operation to ensure the safety of the public and to protect public resource identified above. Use additional sheets as needed.					
All operations will be carried out in cooperation with the Allegheny National Forest.					
US Fish and Wildlife Service, trees will not be cut during the summer occupancy season, April 1-September 30.					
PA Game Commission defers to USFWS					

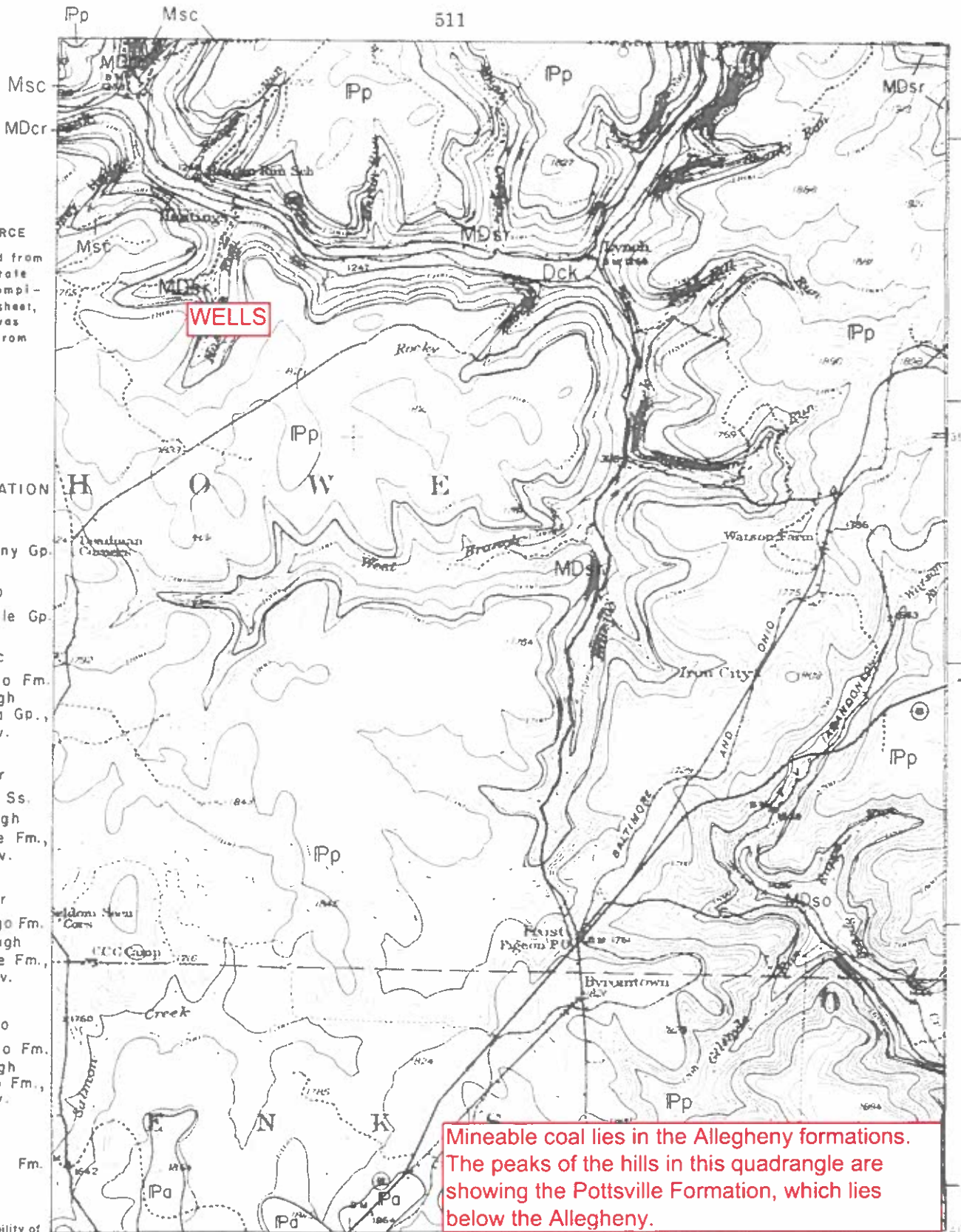

**SOURCE**  
 Modified from 1960 state map compilation sheet, which was taken from M 38.

**EXPLANATION**

- IPa Allegheny Gp.
- IPp Pottsville Gp.
- Msc Shenango Fm. through Cuyahoga Gp., undiv.
- MDcr Corry Ss. through Riceville Fm., undiv.
- MDsr Shenango Fm. through Riceville Fm., undiv.
- MDso Shenango Fm. through Oswayo Fm., undiv.
- Dck Catskill Fm.

Mineable coal lies in the Allegheny formations. The peaks of the hills in this quadrangle are showing the Pottsville Formation, which lies below the Allegheny.

NOTE: Reliability of contacts is poor.

**REFERENCE**

Ingham, A. I., Lytle, W. S., Matteson, L. S., and Sherrill, R. E. (1956). *Oil and gas geology of the Sheffield quadrangle, Pennsylvania*, Pennsylvania Geological Survey, 4th ser., Mineral Resource Report 38, 72 p.



## 1. PROJECT INFORMATION

Project Name: **Hastings Scorpio Package 1 and Package 2**

Date of Review: **9/25/2025 12:52:26 PM**

Project Category: **Energy Storage, Production, and Transfer, Energy Production (generation), Oil or Gas - new wells, expansion of well field**

Project Area: **77.74 acres**

County(s): **Forest**

Township/Municipality(s): **Howe Township**

ZIP Code:

Quadrangle Name(s): **LYNCH**

Watersheds HUC 8: **Middle Allegheny-Tionesta**

Watersheds HUC 12: **Lower Sheriff Run-Tionesta Creek**

Decimal Degrees: **41.594924, -79.100670**

Degrees Minutes Seconds: **41° 35' 41.7256" N, 79° 6' 2.4126" W**

## 2. SEARCH RESULTS

Agency	Results	Response
PA Game Commission	<b>Conservation Measure</b>	<b>No Further Review Required, See Agency Comments</b>
PA Department of Conservation and Natural Resources	No Known Impact	No Further Review Required
PA Fish and Boat Commission	No Known Impact	No Further Review Required
U.S. Fish and Wildlife Service	<b>Potential Impact</b>	<b>MORE INFORMATION REQUIRED, See Agency Response</b>

As summarized above, Pennsylvania Natural Diversity Inventory (PNDI) records indicate there may be potential impacts to threatened and endangered and/or special concern species and resources within the project area. If the response above indicates "No Further Review Required" no additional communication with the respective agency is required. If the response is "Further Review Required" or "See Agency Response," refer to the appropriate agency comments below. Please see the DEP Information Section of this receipt if a PA Department of Environmental Protection Permit is required.

### Hastings Scorpio Package 1 and Package 2



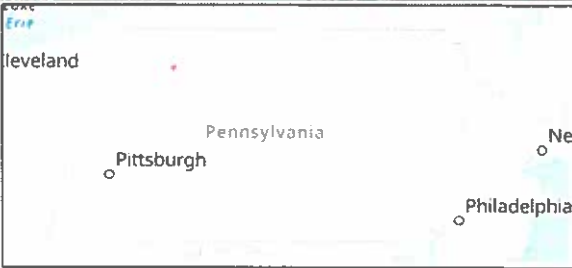

-  Buffered Project Boundary
-  Project Boundary

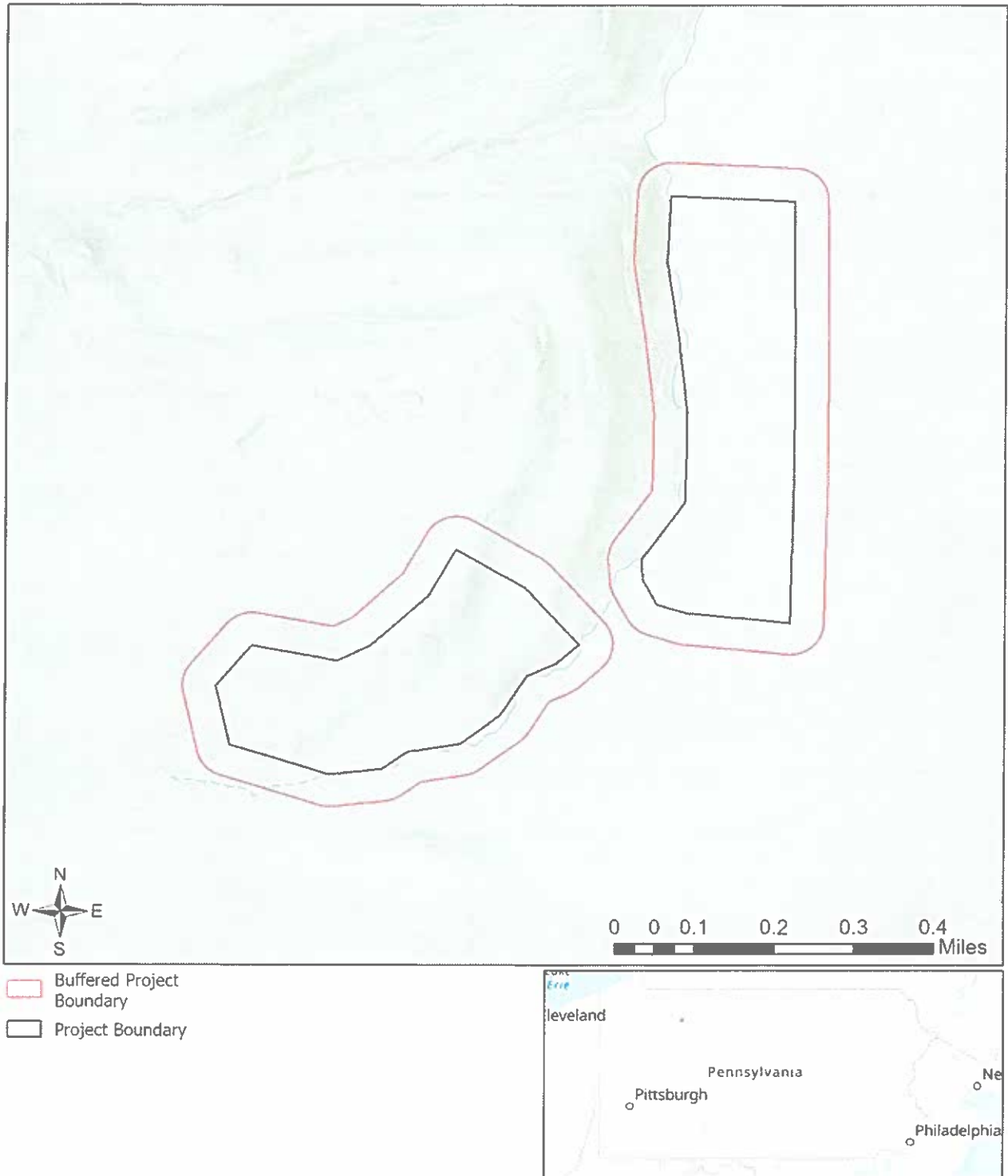

Source: Esri, Maxar, Earthstar Geographics, and the GIS User Community  
Sources: Esri, TomTom, Garmin, FAO, NOAA, USGS, © OpenStreetMap contributors, and the GIS User Community

### Hastings Scorpio Package 1 and Package 2



-  Buffered Project Boundary
-  Project Boundary

Sources: Esri, TomTom, Garmin, FAO, NOAA, USGS, OpenStreetMap contributors, and the GIS User Community  
Sources: Esri, Maxar, Airbus DS, USGS, NGA, NASA, CGIAR, N Robinson, NCEAS, NLS, OS, NMA, Geodatastyrelsen, Rijkswaterstaat, GSA

## RESPONSE TO QUESTION(S) ASKED

**Q1:** Will the action include disturbance to trees such as tree cutting (or other means of knocking down, or bringing down trees, tree topping, or tree trimming), pesticide/herbicide application or prescribed fire?

**Your answer is:** Yes

**Q2:** Does the action area contain any caves (or associated sinkholes, fissures, or other karst features), mines, rocky outcroppings, culverts, or tunnels that could provide habitat for hibernating bats?

**Your answer is:** No

### 3. AGENCY COMMENTS

Regardless of whether a DEP permit is necessary for this proposed project, any potential impacts to threatened and endangered species and/or special concern species and resources must be resolved with the appropriate jurisdictional agency. In some cases, a permit or authorization from the jurisdictional agency may be needed if adverse impacts to these species and habitats cannot be avoided.

These agency determinations and responses are **valid for two years** (from the date of the review), and are based on the project information that was provided, including the exact project location; the project type, description, and features; and any responses to questions that were generated during this search. If any of the following change: 1) project location, 2) project size or configuration, 3) project type, or 4) responses to the questions that were asked during the online review, the results of this review are not valid, and the review must be searched again via the PNDI Environmental Review Tool and resubmitted to the jurisdictional agencies. The PNDI tool is a primary screening tool, and a desktop review may reveal more or fewer impacts than what is listed on this PNDI receipt. The jurisdictional agencies **strongly advise against** conducting surveys for the species listed on the receipt prior to consultation with the agencies.

#### PA Game Commission

##### RESPONSE:

Conservation Measure: Potential impacts to state and federally listed species which are under the jurisdiction of both the Pennsylvania Game Commission (PGC) and the U.S. Fish and Wildlife Service may occur as a result of this project. As a result, the PGC defers comments on potential impacts to federally listed species to the U.S. Fish and Wildlife Service. No further coordination with the Pennsylvania Game Commission is required at this time.

#### PA Department of Conservation and Natural Resources

##### RESPONSE:

No Impact is anticipated to threatened and endangered species and/or special concern species and resources.

#### PA Fish and Boat Commission

##### RESPONSE:

No Impact is anticipated to threatened and endangered species and/or special concern species and resources.

#### U.S. Fish and Wildlife Service

##### RESPONSE:

Information Request: Your project is within the range of the federally listed northern long-eared bat. Enter project information into IPaC (<http://ecos.fws.gov/ipac/>). Follow the step-by-step process to review this project's potential effect on federally listed species. For step-by-step instructions, please see our Project Review Page (<https://www.fws.gov/office/pennsylvania-ecological-services/project-revi...>)

## WHAT TO SEND TO JURISDICTIONAL AGENCIES

If project information was requested by one or more of the agencies above, upload\* or email the following information to the agency(s) (see AGENCY CONTACT INFORMATION). Instructions for uploading project materials can be found [here](#). This option provides the applicant with the convenience of sending project materials to a single location accessible to all three state agencies (but not USFWS).

\*If information was requested by USFWS, applicants must submit their project using [IPaC](#), following the [USFWS Project Submission](#) Instructions. USFWS will not accept or review project materials uploaded via the Conservation Explorer.

### Check-list of Minimum Materials to be submitted:

\_\_\_ Project narrative with a description of the overall project, the work to be performed, current physical characteristics of the site and acreage to be impacted.

\_\_\_ A map with the project boundary and/or a basic site plan (particularly showing the relationship of the project to the physical features such as wetlands, streams, ponds, rock outcrops, etc.)

**In addition to the materials listed above, USFWS REQUIRES the following**

\_\_\_ **SIGNED** copy of a Final Project Environmental Review Receipt

### The inclusion of the following information may expedite the review process.

\_\_\_ Color photos keyed to the basic site plan (i.e. showing on the site plan where and in what direction each photo was taken and the date of the photos)

\_\_\_ Information about the presence and location of wetlands in the project area, and how this was determined (e.g., by a qualified wetlands biologist), if wetlands are present in the project area, provide project plans showing the location of all project features, as well as wetlands and streams.

## 4. DEP INFORMATION

The Pa Department of Environmental Protection (DEP) requires that a signed copy of this receipt, along with any required documentation from jurisdictional agencies concerning resolution of potential impacts, be submitted with applications for permits requiring PNDI review. Two review options are available to permit applicants for handling PNDI coordination in conjunction with DEP's permit review process involving either T&E Species or species of special concern. Under sequential review, the permit applicant performs a PNDI screening and completes all coordination with the appropriate jurisdictional agencies prior to submitting the permit application. The applicant will include with its application, both a PNDI receipt and/or a clearance letter from the jurisdictional agency if the PNDI Receipt shows a Potential Impact to a species or the applicant chooses to obtain letters directly from the jurisdictional agencies. Under concurrent review, DEP, where feasible, will allow technical review of the permit to occur concurrently with the T&E species consultation with the jurisdictional agency. The applicant must still supply a copy of the PNDI Receipt with its permit application. The PNDI Receipt should also be submitted to the appropriate agency according to directions on the PNDI Receipt. The applicant and the jurisdictional agency will work together to resolve the potential impact(s). See the DEP PNDI policy at <https://conservationexplorer.dcnr.pa.gov/content/resources>.

### 5. ADDITIONAL INFORMATION

The PNDI environmental review website is a preliminary screening tool. There are often delays in updating species status classifications. Because the proposed status represents the best available information regarding the conservation status of the species, state jurisdictional agency staff give the proposed statuses at least the same consideration as the current legal status. If surveys or further information reveal that a threatened and endangered and/or special concern species and resources exist in your project area, contact the appropriate jurisdictional agency/agencies immediately to identify and resolve any impacts.

For a list of species known to occur in the county where your project is located, please see the species lists by county found on the PA Natural Heritage Program (PNHP) home page ([www.naturalheritage.state.pa.us](http://www.naturalheritage.state.pa.us)). Also note that the PNDI Environmental Review Tool only contains information about species occurrences that have actually been reported to the PNHP.

### 6. AGENCY CONTACT INFORMATION

#### PA Department of Conservation and Natural Resources

Bureau of Forestry, Ecological Services Section  
400 Market Street, PO Box 8552  
Harrisburg, PA 17105-8552  
Email: [RA-HeritageReview@pa.gov](mailto:RA-HeritageReview@pa.gov)

#### U.S. Fish and Wildlife Service

Pennsylvania Field Office  
Endangered Species Section  
110 Radnor Rd; Suite 101  
State College, PA 16801  
Email: [IR1\\_ESPenn@fws.gov](mailto:IR1_ESPenn@fws.gov)  
NO Faxes Please

#### PA Fish and Boat Commission

Division of Environmental Services  
595 E. Rolling Ridge Dr., Bellefonte, PA 16823  
Email: [RA-FBPACENOTIFY@pa.gov](mailto:RA-FBPACENOTIFY@pa.gov)

#### PA Game Commission

Bureau of Wildlife Management  
Division of Environmental Review  
2001 Elmerton Avenue, Harrisburg, PA 17110-9797  
Email: [RA-PGC\\_PNDI@pa.gov](mailto:RA-PGC_PNDI@pa.gov)  
NO Faxes Please

### 7. PROJECT CONTACT INFORMATION

Name: Philip L. Hampson  
Company/Business Name: Hampson Surveying  
Address: 105 Willoughby Avenue  
City, State, Zip: Warren, PA 16365  
Phone: (814) 730-1822 Fax: ( )  
Email: hampson@westpa.net

### 8. CERTIFICATION

I certify that ALL of the project information contained in this receipt (including project location, project size/configuration, project type, answers to questions) is true, accurate and complete. In addition, if the project type, location, size or configuration changes, or if the answers to any questions that were asked during this online review change, I agree to re-do the online environmental review.

**Philip Hampson**  
applicant/project proponent signature

Digitally signed by **Philip Hampson**  
Date: 2025.10.07 11:50:12 -04'00'

10/7/2025  
date



## United States Department of the Interior



FISH AND WILDLIFE SERVICE  
Pennsylvania Ecological Services Field Office  
110 Radnor Road Suite 101  
State College, PA 16801-7987  
Phone: (814) 234-4090 Fax: (814) 234-0748

In Reply Refer To:  
Project code: 2025-0154675  
Project Name: Scorpio Hastings well packages 1 and 2

09/25/2025 16:38:46 UTC

Federal Nexus: no  
Federal Action Agency (if applicable):

**Subject:** Technical assistance for 'Scorpio Hastings well packages 1 and 2'

Dear Philip Hampson:

This letter records your determination using the Information for Planning and Consultation (IPaC) system provided to the U.S. Fish and Wildlife Service (Service) on September 25, 2025, for 'Scorpio Hastings well packages 1 and 2' (here forward, Project). This project has been assigned Project Code 2025-0154675 and all future correspondence should clearly reference this number. **Please carefully review this letter. Your Endangered Species Act (Act) requirements may not be complete.**

### **Ensuring Accurate Determinations When Using IPaC**

The Service developed the IPaC system and associated species' determination keys in accordance with the Endangered Species Act of 1973 (ESA; 87 Stat. 884, as amended; 16 U.S.C. 1531 et seq.) and based on a standing analysis. All information submitted by the Project proponent into IPaC must accurately represent the full scope and details of the Project.

Failure to accurately represent or implement the Project as detailed in IPaC or the Northern Long-eared Bat and Tricolored Bat Range-wide Determination Key (Dkey), invalidates this letter. ***Answers to certain questions in the DKey commit the project proponent to implementation of conservation measures that must be followed for the ESA determination to remain valid. Note that conservation measures for northern long-eared bat and tricolored bat may differ. If both bat species are present in the action area and the key suggests more conservative measures for one of the species for your project, the Project may need to apply the most conservative measures in order to avoid adverse effects. If unsure which conservation measures should be applied, please contact the appropriate Ecological Services Field Office***

**Determination for the Northern Long-Eared Bat and Tricolored Bat**

Based upon your IPaC submission and a standing analysis completed by the Service, your project has reached the following effect determination(s):

Species	Listing Status	Determination
Northern Long-eared Bat ( <i>Myotis septentrionalis</i> )	Endangered	NLAA

### Other Species and Critical Habitat that May be Present in the Action Area

The IPaC-assisted determination key for the northern long-eared bat and tricolored bat does not apply to the following ESA-protected species and/or critical habitat that also may occur in your Action area:

- Monarch Butterfly *Danaus plexippus* Proposed Threatened

You may coordinate with our Office to determine whether the Action may cause prohibited take of the animal species and/or critical habitat listed above. Note that if a new species is listed that may be affected by the identified action before it is complete, additional review is recommended to ensure compliance with the Endangered Species Act.

### Next Steps

Coordination with the Service is complete. This letter serves as technical assistance. All conservation measures should be implemented as proposed. Thank you for considering federally listed species during your project planning.

If no changes occur with the Project or there are no updates on listed species, no further consultation/coordination for this project is required for the northern long-eared bat. However, the Service recommends that project proponents re-evaluate the Project in IPaC if: 1) the scope, timing, duration, or location of the Project changes (includes any project changes or amendments); 2) new information reveals the Project may impact (positively or negatively) federally listed species or designated critical habitat; or 3) a new species is listed, or critical habitat designated. If any of the above conditions occurs, additional coordination with the Service should take place before project implements any changes which are final or commits additional resources.

If you have any questions regarding this letter or need further assistance, please contact the Pennsylvania Ecological Services Field Office and reference Project Code 2025-0154675 associated with this Project.

**Action Description**

You provided to IPaC the following name and description for the subject Action.

**1. Name**

Scorpio Hastings well packages 1 and 2

**2. Description**

The following description was provided for the project 'Scorpio Hastings well packages 1 and 2':

Oil and gas exploration projects, two separate projects.

The approximate location of the project can be viewed in Google Maps: <https://www.google.com/maps/@41.59060955,-79.10789103582192,14z>



## DETERMINATION KEY RESULT

Based on the answers provided, the proposed Action is consistent with a determination of “may affect, but not likely to adversely affect” for a least one species covered by this determination key.

## QUALIFICATION INTERVIEW

1. Does the proposed project include, or is it reasonably certain to cause, intentional take of listed bats or any other listed species?

**Note:** Intentional take is defined as take that is the intended result of a project. Intentional take could refer to research, direct species management, surveys, and/or studies that include intentional handling/encountering, harassment, collection, or capturing of any individual of a federally listed threatened, endangered or proposed species?

*No*

2. Is the action area wholly within Zone 2 of the year-round active area for northern long-eared bat and/or tricolored bat?

**Automatically answered**

*No*

3. Does the action area intersect Zone 1 of the year-round active area for northern long-eared bat and/or tricolored bat?

**Automatically answered**

*No*

4. Does any component of the action involve leasing, construction or operation of wind turbines? Answer 'yes' if the activities considered are conducted with the intention of gathering survey information to inform the leasing, construction, or operation of wind turbines.

*No*

5. Is the proposed action authorized, permitted, licensed, funded, or being carried out by a Federal agency in whole or in part?

**Note for projects in Pennsylvania:** Projects requiring authorization under Section 404 of the Clean Water Act and/or Section 10 of the Rivers and Harbors Act would be considered as having a federal nexus. Since the U.S. Army Corps of Engineers (Corps) has issued the Pennsylvania State Programmatic General Permit (PASPGP), which may be verified by the PA Department of Environmental Protection or certain Conservation Districts, the need to receive a Corps authorization to perform the work under the PASPGP serves as a federal nexus. As such, if proposing to use the PASPGP, you would answer 'yes' to this question.

*No*

6. [Semantic] Is the action area located within 0.5 miles of a known bat hibernaculum or winter roost? **Note:** The map queried for this question contains proprietary information and cannot be displayed. If you need additional information, please contact your state wildlife agency.

**Automatically answered**

No

7. Does the action area contain any winter roosts or caves (or associated sinkholes, fissures, or other karst features), mines, rocky outcroppings, or tunnels that could provide habitat for hibernating bats?

No

8. Does the action area contain (1) talus or (2) anthropogenic or naturally formed rock shelters or crevices in rocky outcrops, rock faces or cliffs?

No

9. Will the action cause effects to a bridge?

**Note:** Covered bridges should be considered as bridges in this question.

No

10. Will the action result in effects to a culvert or tunnel at any time of year?

No

11. Are trees present within 1000 feet of the action area?

**Note:** If there are trees within the action area that are of a sufficient size to be potential roosts for bats answer "Yes". If unsure, additional information defining suitable summer habitat for the northern long-eared bat and tricolored bat can be found in Appendix A of the USFWS' Range-wide Indiana Bat and Northern long-eared bat Survey Guidelines at: <https://www.fws.gov/media/range-wide-indiana-bat-and-northern-long-eared-bat-survey-guidelines>.

Yes

12. Does the action include the intentional exclusion of bats from a building or building-like structure? **Note:** Exclusion is conducted to deny bats' entry or reentry into a building. To be effective and to avoid harming bats, it should be done according to established standards. If your action includes bat exclusion and you are unsure whether northern long-eared bats or tricolored bats are present, answer "Yes." Answer "No" if there are no signs of bat use in the building/structure. If unsure, contact your local Ecological Services Field Office to help assess whether northern long-eared bats or tricolored bats may be present. Contact a Nuisance Wildlife Control Operator (NWCO) for help in how to exclude bats from a structure safely without causing harm to the bats (to find a NWCO certified in bat standards, search the Internet using the search term "National Wildlife Control Operators Association bats"). Also see the White-Nose Syndrome Response Team's guide for bat control in structures.

No

13. Does the action involve removal, modification, or maintenance of a human-made building-like structure (barn, house, or other building) **known or suspected to contain roosting bats?**

No

14. Will the action cause construction of one or more new roads open to the public?

For federal actions, answer 'yes' when the construction or operation of these facilities is either (1) part of the federal action or (2) would not occur but for an action taken by a federal agency (federal permit, funding, etc.).

No

15. Will the action include or cause any construction or other activity that is reasonably certain to increase average night-time traffic permanently or temporarily on one or more existing roads? **Note:** For federal actions, answer 'yes' when the construction or operation of these facilities is either (1) part of the federal action or (2) would not occur but for an action taken by a federal agency (federal permit, funding, etc.).

No

16. Will the action include or cause any construction or other activity that is reasonably certain to increase the number of travel lanes on an existing thoroughfare?

For federal actions, answer 'yes' when the construction or operation of these facilities is either (1) part of the federal action or (2) would not occur but for an action taken by a federal agency (federal permit, funding, etc.).

No

17. Will the proposed Action involve the creation of a new water-borne contaminant source (e.g., leachate pond, pits containing chemicals that are not NSF/ANSI 60 compliant)?

**Note:** For information regarding NSF/ANSI 60 please visit <https://www.nsf.org/knowledge-library/nsf-ansi-standard-60-drinking-water-treatment-chemicals-health-effects>

No

18. Will the proposed action involve the creation of a new point source discharge from a facility other than a water treatment plant or storm water system?

No

19. Will the action include drilling or blasting?

Yes

20. Will the drilling or blasting produce noise or vibrations above existing background levels that will affect suitable summer habitat for northern long-eared bats and/or tricolored bats?

**Note:** Additional information defining suitable suitable summer habitat for the northern long-eared bat and/or tricolored bat, can be found in Appendix A in the USFWS' Range-wide Indiana Bat and Northern long-eared Bat Survey Guidelines at: <https://www.fws.gov/media/range-wide-indiana-bat-and-northern-long-eared-bat-survey-guidelines>

No

21. Will the action involve military training (e.g., smoke operations, obscurant operations, exploding munitions, artillery fire, range use, helicopter or fixed wing aircraft use at night)?

No

22. Will the proposed action involve the use of herbicides or pesticides (e.g., fungicides, insecticides, or rodenticides)?

No

23. Will the action include or cause activities that are reasonably certain to cause chronic or intense nighttime noise (above current levels of ambient noise in the area) in suitable summer habitat for the northern long-eared bat or tricolored bat during the active season?

Chronic noise is noise that is continuous or occurs repeatedly again and again for a long time. Sources of chronic or intense noise that could cause adverse effects to bats may include, but are not limited to: road traffic; trains; aircraft; industrial activities; gas compressor stations; loud music; crowds; oil and gas extraction; construction; and mining.

**Note:** Additional information defining suitable summer habitat for the northern long-eared bat and tricolored bat can be found in Appendix A of the USFWS' Range-wide Indiana Bat and Northern long-eared bat Survey Guidelines at: <https://www.fws.gov/media/range-wide-indiana-bat-and-northern-long-eared-bat-survey-guidelines>.

No

24. Does the action include, or is it reasonably certain to cause, the use of permanent or temporary artificial lighting within 1000 feet of suitable northern long-eared bat or tricolored bat roosting habitat?

**Note:** Additional information defining suitable summer habitat for the northern long-eared bat and tricolored bat can be found in Appendix A of the USFWS' Range-wide Indiana Bat and Northern long-eared bat Survey Guidelines at: <https://www.fws.gov/media/range-wide-indiana-bat-and-northern-long-eared-bat-survey-guidelines>.

No

25. Will the action include tree cutting or other means of knocking down or bringing down trees, tree topping, or tree trimming?

Yes

26. Is the project related to the production of coal, including projects that support the mining of coal, as well as the production and/or distribution of energy produced from coal?

*No*

27. Will the proposed action occur exclusively in an already established and currently maintained utility right-of-way?

*No*

28. Does the action include emergency cutting or trimming of hazard trees in order to remove an imminent threat to human safety or property? See hazard tree note at the bottom of the key for text that will be added to response letters

**Note:** A "hazard tree" is a tree that is an immediate threat to lives, public health and safety, or improved property.

*No*

29. Does the project intersect with the 0- 9.9% forest density category?

**Automatically answered**

*No*

30. Does the project intersect with the 10.0- 19.9% forest density category map?

**Automatically answered**

*No*

31. Does the project intersect with the 20.0- 29.9% forest density category map?

**Automatically answered**

*No*

32. Does the project intersect with the 30.0- 100% forest density category map?

**Automatically answered**

*Yes*

33. Will the action cause trees to be cut, knocked down, or otherwise brought down across an area greater than 100 acres in total extent?

*No*

34. Will the proposed action result in the use of prescribed fire?

**Note:** If the prescribed fire action includes other activities than application of fire (e.g., tree cutting, fire line preparation) please consider impacts from those activities within the previous representative questions in the key. This set of questions only considers impacts from flame and smoke.

*No*

35. Does the action area intersect the northern long-eared bat species list area?

**Automatically answered**

*Yes*

36. [Semantic] Is the action area located within 0.5 miles of radius of an entrance/opening to any known NLEB hibernacula or winter roost? **Note:** The map queried for this question contains proprietary information and cannot be displayed. If you need additional information, please contact your State wildlife agency.

**Automatically answered**

No

37. [Semantic] Is the action area located within 0.25 miles of a culvert that is known to be occupied by northern long-eared or tricolored bats? **Note:** The map queried for this question contains proprietary information and cannot be displayed. If you need additional information, please contact your State wildlife agency.

**Automatically answered**

No

38. [Semantic] Is the action area located within 150 feet of a documented northern long-eared bat roost site?

**Note:** The map queried for this question contains proprietary information and cannot be displayed. If you need additional information, please contact your State wildlife agency. Have you contacted the appropriate agency to determine if your action is within 150 feet of any documented northern long-eared bat roosts?

**Note:** A document with links to Natural Heritage Inventory databases and other state-specific sources of information on the locations of northern long-eared bat roosts is available here. Location information for northern long-eared bat roosts is generally kept in state natural heritage inventory databases – the availability of this data varies by state. Many states provide online access to their data, either directly by providing maps or by providing the opportunity to make a data request. In some cases, to protect those resources, access to the information may be limited.

**Automatically answered**

No

39. Is suitable summer habitat for the northern long-eared bat present within 1000 feet of project activities?

If unsure, answer "Yes."

**Note:** Additional information defining suitable summer habitat for the northern long-eared bat and tricolored bat can be found in Appendix A of the USFWS' Range-wide Indiana Bat and Northern long-eared bat Survey Guidelines at: <https://www.fws.gov/media/range-wide-indiana-bat-and-northern-long-eared-bat-survey-guidelines>.

Yes

40. Are any of the trees proposed for cutting or other means of knocking down, bringing down, topping, or trimming suitable for northern long-eared bat roosting (i.e., live trees and/or snags  $\geq 3$  inches dbh that have exfoliating bark, cracks, crevices, and/or cavities)?

**Note:** Additional information defining suitable summer habitat for the northern long-eared bat and tricolored bat can be found in Appendix A of the USFWS' Range-wide Indiana Bat and Northern long-eared bat Survey Guidelines at: <https://www.fws.gov/media/range-wide-indiana-bat-and-northern-long-eared-bat-survey-guidelines>.

Yes

41. Will any tree cutting/trimming or other knocking or bringing down of trees occur during the **Summer Occupancy season** for northern long-eared bats in the action area? **Note:** Bat activity periods for your state can be found in Appendix 2 of the Service's [Northern long-eared Bat and Tricolored Bat Voluntary Environmental Review Process for Development Projects](#).

No

42. Do you have any documents that you want to include with this submission?

No

## PROJECT QUESTIONNAIRE

Enter the extent of the action area (in acres) from which trees will be removed - round up to the nearest tenth of an acre. For this question, include the entire area where tree removal will take place, even if some live or dead trees will be left standing.

5

## IPAC USER CONTACT INFORMATION

Agency: Private Entity  
Name: Philip Hampson  
Address: 105 Willoughby Avenue  
City: Warren  
State: PA  
Zip: 16365  
Email: hampson@westpa.net  
Phone: 8147301822



COMMONWEALTH OF PENNSYLVANIA  
DEPARTMENT OF ENVIRONMENTAL PROTECTION  
OIL & GAS MANAGEMENT PROGRAM

DEP USE ONLY	
Auth # 1559766	APS # 1156828
Site # 886349	Facility # 890267
FIX Client #	Sub-fac # 1469956

## Request for Approval of Alternative Waste Management Practices

*Please read instructions on back before completing this form.*

Well Operator Scorpio Energy, Inc.		DEP ID 300597	Well Permit or Registration Number <b>053-31205</b>	
Address 203 Center Street			Well Farm Name Hastings	
City Sheffield	State PA	Zip Code 16347	Well # SDT-69	Serial #
Phone 814-727-7717	Fax 814-727-7718	County Forest County	Municipality Howe Township	

**INTENDED ALTERNATIVE PRACTICE** *Check the appropriate box and complete the applicable section of the form.*

- For temporary containment of fluids and wastes generated during drilling, altering, or completing a well, complete Section A. PITS AND TANKS FOR TEMPORARY CONTAINMENT. See 25 Pa. Code § 78.56 for regulations.
- For disposal of drill cuttings from above the surface casing seat, complete Section B. ALTERNATE WASTE DISPOSAL PRACTICES. See 25 Pa. Code § 78.61 for regulations.
- For disposal of residual waste and drill cuttings from below the surface casing seat, complete Section B. ALTERNATE WASTE DISPOSAL PRACTICES. See 25 Pa. Code § 78.62 or § 78.63 for regulations.
- For onsite pretreatment systems being used to treat frac flowback fluid for reuse/recycling or transportation to a permitted treatment/disposal facility, complete Sections A and C. See 25 PA Code 78.56; 78.61; 78.62 & 78.63 for regulations.

**A. PITS AND TANKS FOR TEMPORARY CONTAINMENT**

Complete this section if requesting approval of an alternative practice for temporary containment of polluttional substances and wastes from drilling, altering, or completing a well. See 25 Pa. Code § 78.56.

- a) Check the box below and fill in the dates the pit will be used if you are requesting a variance from the requirement that the bottom of the pit be at least 20 inches above the seasonal high groundwater table for a pit that exists only during dry times of the year and is located above groundwater. See 25 Pa. Code § 78.56(a)(4)(iii).  
 Variance requested; dates to be used, from \_\_\_\_\_ to \_\_\_\_\_
- b) Check the box below if you are requesting approval of an alternative practice for temporary containment.  
 Approval of an other alternative practice is requested. Describe the type of waste and the temporary containment method. Include information which will demonstrate that the proposed alternative practices will provide equivalent or superior protection to the practices identified in 25 Pa. Code § 78.56.

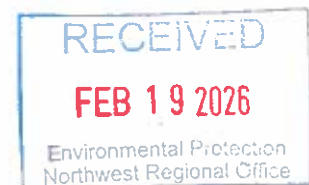

Tech Due Date 04/03/2026  
bgr 2/23/2026

**B. ALTERNATIVE WASTE DISPOSAL PRACTICES**

Complete this section if requesting approval of an alternative practice to dispose of drill cuttings or residual wastes at the well site. Describe the type of waste, including any additives, and the proposed alternative practice. Include information that will demonstrate the proposed practice will provide protection equivalent or superior to the practices identified in 25 Pa. Code § 78.61, 78.62, or 78.63.

Scorpio Energy, LLC is requesting DEP approval for disposal of uncontaminated drill cuttings into a structurally sound and unlined drill pit.

Before the drill cuttings enter the pit, fresh water will be injected into the blooie line, eliminating dust. The pit will be located more than 100' from a stream or wetland and 200' from an existing building or water supply.

Hastings Run (CWF) lies +/-530' south of the clearing limits, there aren't any wetlands or buildings within 400' of the project.

The attached site plan depict well and pit location (depending upon soils, drainage and other conditions observed during construction) and any stream, wetland or building that may be within 250' of the well.

According to the Map Unit Description of Warren and Forest Counties, the soil at the well location is Cookport Silt Loam (CvC).

Historical records indicate fresh water will be encountered at a depth of +/- 400'.

A second pit will be utilized for fracing.

The pit will be backfilled, graded and seeded and mulched.

Ph and conductivity will be tested and reported according to regulations.

**C. ONSITE PRETREATMENT OF DRILLING FLUIDS OR FRAC FLOWBACK FLUID**

Complete this section if requesting approval of an onsite mobile pretreatment system for drilling fluids and/or frac flowback for recycling/reuse or transportation to a permitted treatment/disposal facility.

a) Check the appropriate box or boxes that best describe the planned treatment on site.

Use of chemicals or technologies not part of the original permitted well site or in the PPC plan.

Storage of drilling fluids or frac flowback for recycle/reuse.

Transportation of drilling fluids or frac flowback for recycle/reuse.

Disposal of the original waste stream and/or any new waste streams created through pretreatment at an approved permitted facility.

b) Provide a narrative description for all boxes checked above including pretreatment facility design and methodology (use additional pages if necessary)

c) Company/contractor for the onsite treatment facility including name, address, contact person and contact information.

d) Disposal location and permit number for all residual waste generated from the treatment process:

**SIGNATURE OF APPLICANT**

Signature of Applicant / Well Operator

Print or Type Signer's Name and Title  
Gayle Tachoir, President

Date

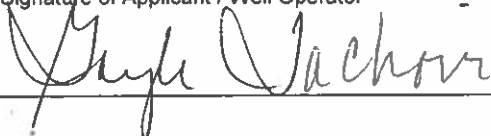

10-8-25

<b>DEP USE ONLY</b>			
<input type="checkbox"/> Approved	<input checked="" type="checkbox"/> Denied	Conditions: <input type="checkbox"/> YES, see below or attached.	Date
DEP Representative: Brian Ayers		<input type="checkbox"/> NO	03.03.26
<p>Conditions:</p> <p>A site evaluation determined that this site is unsuited for the proposed Alternate Waste Management Practices. The operator may resubmit the Request for Approval of Alternate Waste Management Practices if they can demonstrate that shallow groundwater will not compromise the drill pit on this well site.</p>			

**Instructions**

Use this form to apply for approval of alternative waste management practices under 25 Pa. Code § 78.56, 78.61, 78.62, or 78.63.

Complete this form and submit it with all other necessary documentation. Label each attachment with applicant's name and the information item it refers to.

Send your application to the Oil and Gas Management Program at the appropriate DEP regional office:

PA DEP  
 Oil & Gas Management Program  
 Northwest Regional Office  
 230 Chestnut Street  
 Meadville, PA 16335-3481  
 Phone: 814-332-6860  
 Fax: 814-332-6121

PA DEP  
 Oil & Gas Management Program  
 Southwest Regional Office  
 400 Waterfront Drive  
 Pittsburgh, PA 15222-4745  
 Phone: 412-442-4015  
 Fax: 412-442-4328

PA DEP  
 Oil & Gas Management Program  
 Northcentral Regional Office  
 208 West Third Street  
 Williamsport, PA 17701-6448  
 Phone: 570-321-6550  
 Fax: 570-327-3565



COMMONWEALTH OF PENNSYLVANIA  
DEPARTMENT OF ENVIRONMENTAL PROTECTION  
OFFICE OF OIL AND GAS MANAGEMENT  
**WELL LOCATION PLAT**

DEP	Auth ID #:	G:
USE	Permit #:	C:
ONLY	Project #:	

PAGE 1 Surface Location

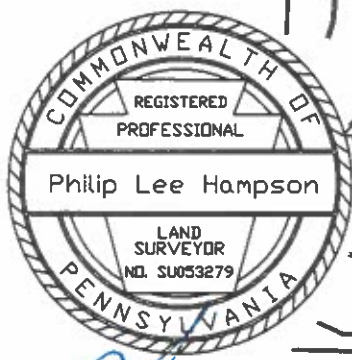
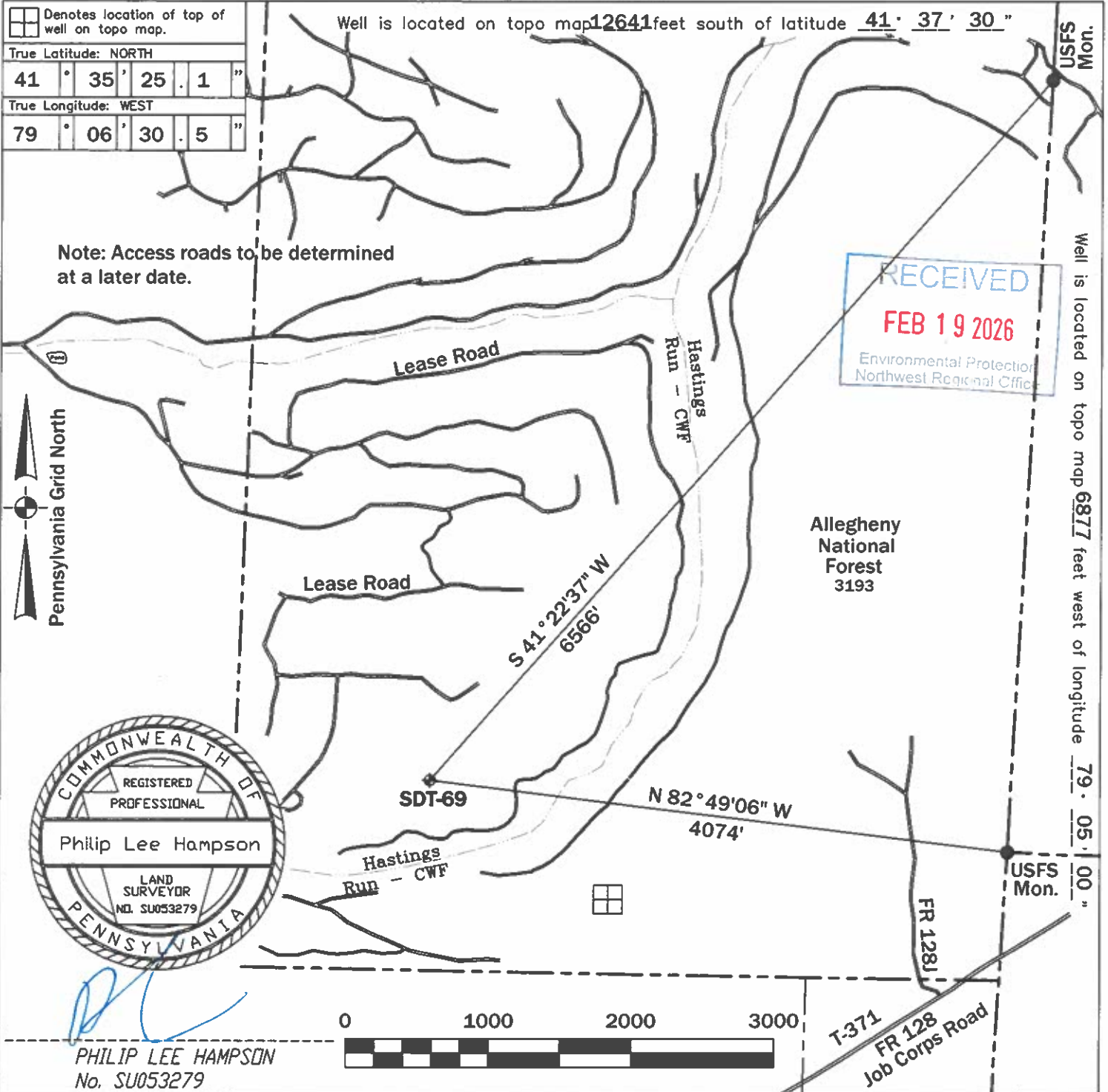

*PHILIP LEE HAMPSON*  
No. SU053279

Applicant/Well Operator Name: Scorpio Energy, Inc.		DEP ID # 300597	Well (Farm) Name: Hastings		Well # SDT-69	Serial #:
Address: 203 Center Street, Sheffield, PA 16347			County: Forest	Municipality: Howe Township	Well Type: Oil	
911 address of well site: N/A			USGS 7½' Quadrangle Map Name: Lynch - 613	Map Section: 1	Surface Elevation: 1736 ft.	
Surveyor or Engineer: Philip L. Hampson, PLS	Phone #: 814-730-1822	Dwg #: SDT-69	Date: 9/23/25	Scale: 1"=1000'	Tract Acreage: +/-950 Acres	
Lat. & Long Metadata Method: Direct GPS		Accuracy: +/-15' ft.	Datum: NAD 83	Elevation Metadata Method: Scaled LIDAR	Datum: NGVD 29	Survey Date: 9/19/25



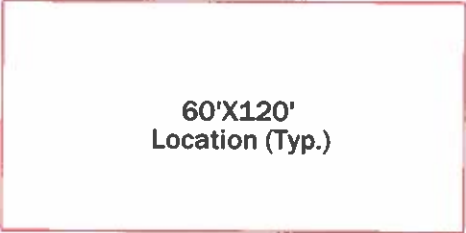
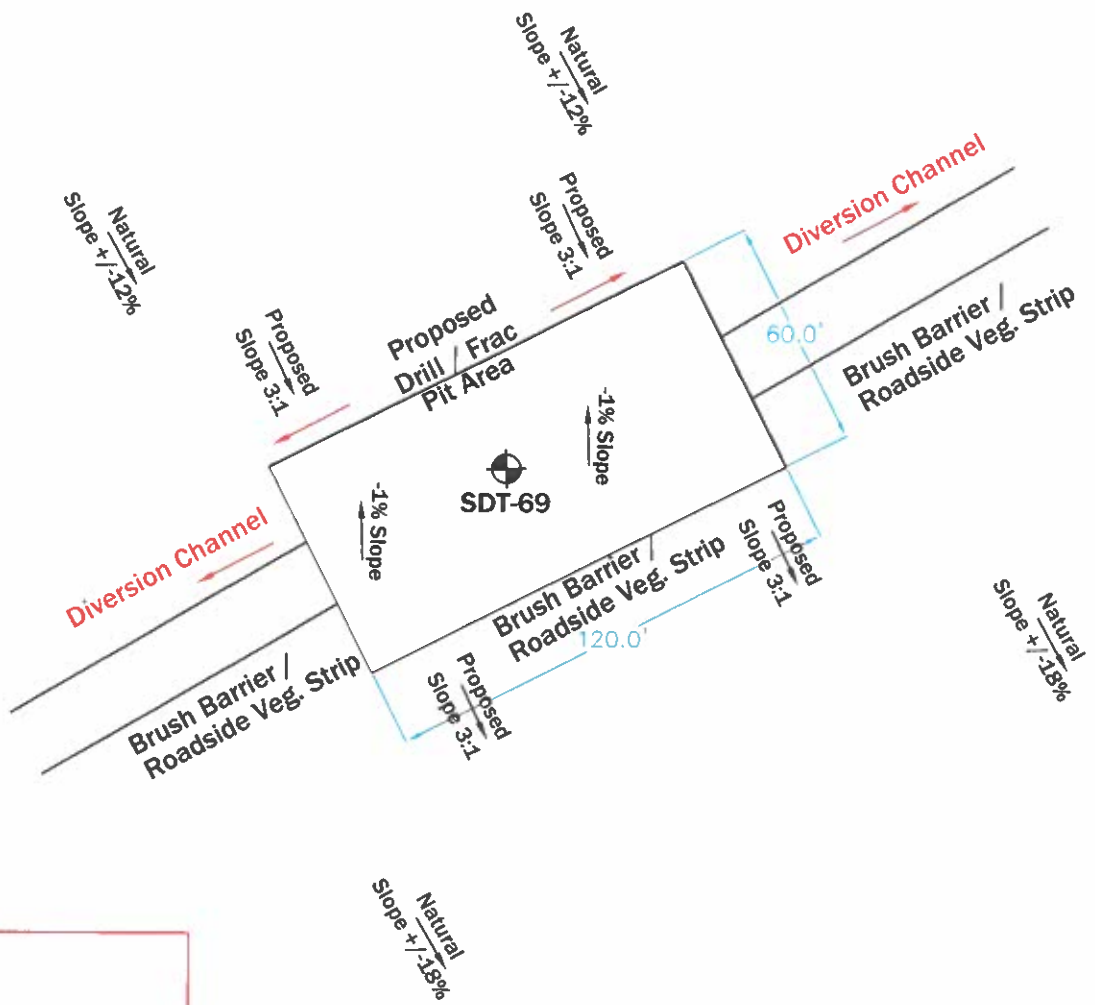

10'X15" Drill / Frac Pit (Typ.)

A minimum of 100' must be maintained between pits and mapped blue line streams.

Note: Diversion Channel must be plugged to prevent drill and frac fluids from leaving the site.

Note: Install energy dissipaters at the out fall of culverts where high flow may cause accelerated erosion.

Note: Use additional erosion and sediment control methods as described in the Erosion and Sediment Control Plan on an as needed basis.

Scale: Not to Scale

Date: 09/24/2025

**HAMPSON SURVEYING**  
105 Willoughby Avenue • Warren, PA 16365  
(814)730-1822 • hampson@westpa.net

Scorpio Energy, Inc. SDT-69  
on  
**Warrant 3193**  
*Allegheny National Forest*  
Howe Township, Forest County  
Pennsylvania