



RECEIVED
2/23/2026

COMMONWEALTH OF PENNSYLVANIA
DEPARTMENT OF ENVIRONMENTAL PROTECTION
OFFICE OF OIL AND GAS MANAGEMENT

DEP USE ONLY
Application Tracking #
1559878

Proposed Alternate Method or Material for Casing, Plugging, Venting or Equipping a Well

Well Operator Leatherwood LLC		DEP ID# 136197	Well Permit or Registration Number 37-059-01471	
Address 275 Technology Drive, Suite 101		Well Farm Name P.L. Elkin		
City Canonsburg	State PA	Zip Code 15317	Well # 600738	Serial # 1060
Phone 724-663-7165	Fax	County Greene	Municipality Morris Twp.	

A proposed alternate method is subject to provisions in §3221 of the 2012 Oil and Gas Act, 58 Pa. C.S. §3221 Section 13 of the Coal and Gas Resource Coordination Act, 58 P.S. §513 and 25 PA Code §§78.75-78.75a (relating to Alternate Methods.) Attach proof of notification of coal operator(s).

Describe in reasonable detail using a written description and / or diagram:

- 1. the proposed alternate method or materials, and**
- 2. the manner in which the alternative will satisfy the goals of the laws and regulations.**

The well bore will be cleaned out to total depth or DEP approved attainable depth. Removal of all free casing will be attempted. In lieu of the coal venting requirements set forth in the PA Code 25, section 78.92 a (3), a solid cement plug of expanding cement will be placed from total depth or DEP approved attainable bottom to the surface.

If it becomes necessary to deviate from this "Proposed Alternate Method" for that portion of the well bore 200 feet below the coal seam to be mined to the surface, approval must be received from the District Oil and Gas Inspector, or the Regional Oil and Gas Supervisor, or the Regional Compliance Manager, or the Regional Program Manager and the coal operator affected. A written record of this permission shall accompany the plugging certificate.

Optional: Approval by Coal Owner or Operator		Signature of Applicant / Well Operator	
Signature 	Date 2/23/2026	Signature 	Date 2/23/2026
Print or Type Signer's Name and Title Craig Jones-Project Engineer-CPCC		Print or Type Signer's Name and Title Patrick Taylor-Project Engineer- Leatherwood	

If optional approval is signed by coal owner or operator, the 15-day objection period may be waived.

DEP USE ONLY		
Approved by (DEP Manager) 	Conditions <input type="checkbox"/> YES, See Attached <input checked="" type="checkbox"/> NO	Date 4/24/2026



COMMONWEALTH OF PENNSYLVANIA
DEPARTMENT OF ENVIRONMENTAL PROTECTION
OFFICE OF OIL AND GAS MANAGEMENT
WELL LOCATION PLAT

DEP	Auth ID #:	G:
USE	Permit #:	C:
ONLY	Project #:	

	Denotes location of top of well on topo map.
True Latitude: NORTH (NAD 1983)	
39° 59' 43.680"	
True Latitude: WEST (NAD 1983)	
80° 18' 20.999"	

Well is located on topo map 1,678 feet south of latitude 40° 00' 00"

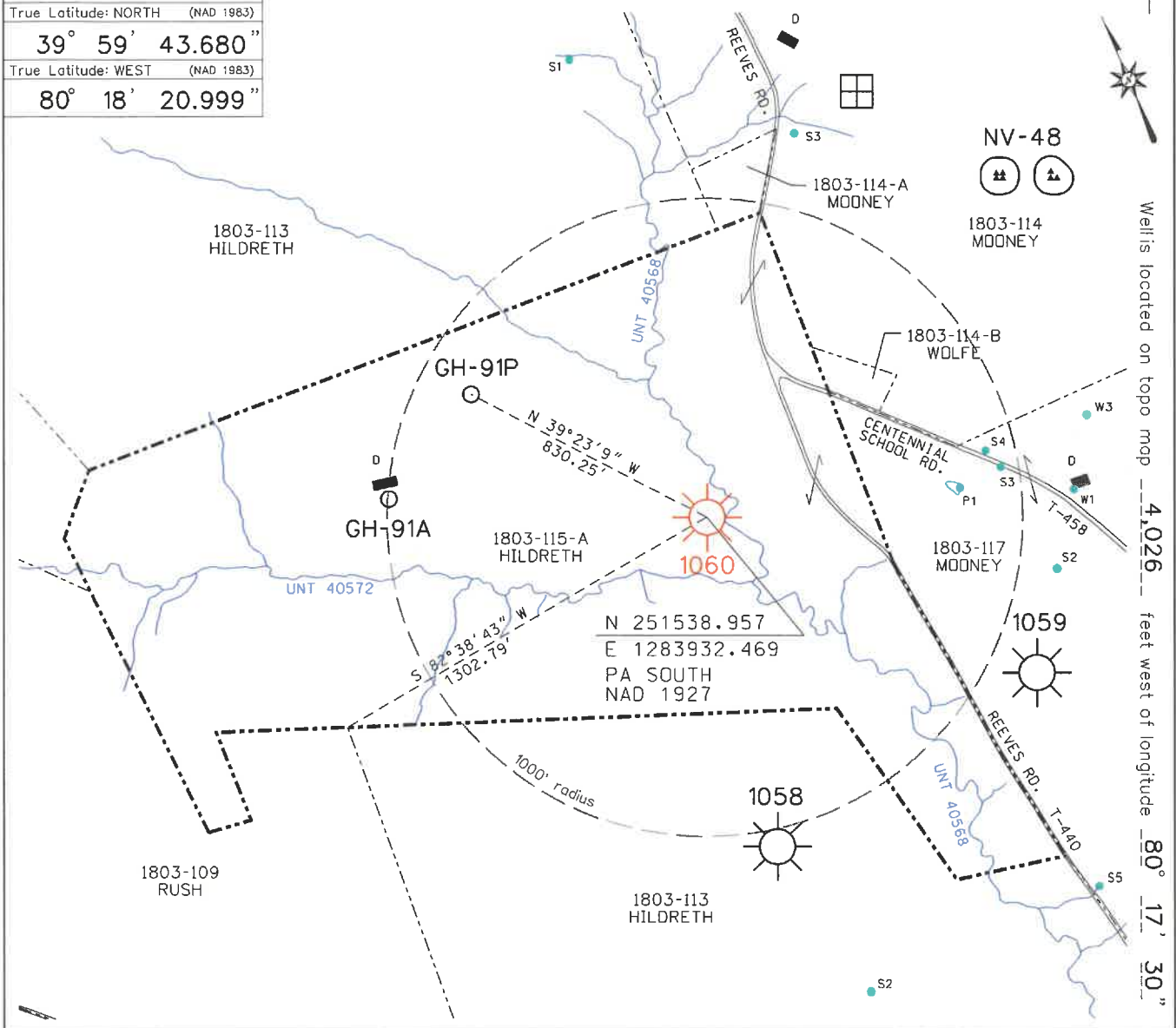

Well is located on topo map 4,026 feet west of longitude 80° 17' 30"

		Enlow Fork Mine		API #: 37-059-01471	
Applicant/Well Operator Name: Leatherwood LLC		DEP ID #: 136197	Well (Farm) Name: P.L. Elkin		Well #: 600738
Address: 275 Technology Dr., Suite 101, Canonsburg, Pa. 15317		County: Greene		Municipality: Morris Twp.	Serial #: Consol-1060
911 address of well site: 399 Reeves Road, Sycamore, Pa. 15364		USGS 7 1/2' Quadrangle Map Name: Rogersville		Map Section: 2	Well Type: Gas
Surface Owner / Lessor: Jeremiah W. Hildreth 399 Reeves Road, Sycamore, Pa. 15364		Tract Acreage: 10+/-		Target Formation:	Surface Elevation: 1177.54 ft.
Surveyor or Engineer: Blue Mountain Engineering	Phone #: 304-662-6486	Dwg #: GW-1060	Scale: 1" = 500'	Date: Feb. 19, 2026	
Lat. & Long Metadata Method: GPS	Accuracy: 1/100,000 ft.	Datum: NAD 1983	Elevation Metadata Method: GPS	Accuracy: 1/100,000 ft.	Datum: NGVD 1929
Surface Owner or Water Purveyor with a Water Supply within 1,000 ft. & Latitude - Longitude of Water Supply.		Owner, Lessee, or Operator of workable Coal Seam		Name of Coal Seam Owned, Leased, or Operated	
1803-117 S3 N 39.99494 W 80.30253		Conrhein Coal Co.		Pittsburgh Coal / OWNER	
1803-117 S4 N 39.99512 W 80.30263		Consol Pennsylvania Coal Co. LLC		Pittsburgh Coal / LESSEE	
1803-117 P1 N 39.99491 W 80.30305		Enlow Fork Mine		Tract: 072-017-2	
		#36-07416 / CMAP #30841317		PK13355-293	



CONSOL ENERGY INC.
275 Technology Drive, Suite 101
Canonsburg, PA 15317

phone: 724-416-8266
email: anthondrezewski@consolenergy.com

Anthony M. Drezewski
Vice President – Land Resources

August 20, 2024

Kevin Wright
Manager of Gas Well Plugging
Consol Pennsylvania Coal Company LLC
275 Technology Drive, Suite 101
Canonsburg, PA 15317

**Re: Pennsylvania Mining Complex
Bailey Mine, Enlow Fork Mine, Harvey Mine
Oil & Gas Well Plugging
Order to Clean Out and Plug Oil & Gas Wells
Washington and Greene Counties, Pennsylvania**

Dear Mr. Wright:

This letter is being executed on behalf of Consol Pennsylvania Coal Company LLC), and CONSOL Thermal Holdings LLC, and Conrhein Coal Company, (hereinafter collectively referred to as, "CONSOL"). In accordance with the requirements set forth in Section 13(a) of the Pennsylvania Coal and Gas Resource Act of 1984, 58 Pa. C.S.A. Section 513(c), please let this letter serve as evidence that adequate notice has been provided to CONSOL as the coal owner/lessee/operator for the plugging of any and all oil & gas wells that need to be plugged for mine through purposes at Bailey, Enlow Fork and Harvey Mines.

Please be advised that CONSOL has no objection to the plugging of the oil & gas wells through the coal seam(s) and I do hereby waive, on behalf of CONSOL, any right CONSOL may have as to prior notification as the coal owner/lessee/operator. CONSOL is not, however, waiving any other rights that it may have.

Sincerely,

**Anthony M. Drezewski – Assistant Vice President
Consol Pennsylvania Coal Company LLC
CONSOL Thermal Holdings LLC**

**Anthony M. Drezewski – Assistant Manager
Conrhein Coal Company**